



## **Najad 370, Smukke Pige / 1994**

### Detailed specification

#### **DATA**

Year:	1994
LOA:	11,25 m
LWL:	9,45 m
Beam:	3,63 m
Draft:	1,80 m
Displacement:	9,7 ton
Hull material:	GRP
Engine:	Volvo Penta MD 22
Designer:	Najadvarvet
Builder:	Najadvarvet, Sweden
Building/hull No.	43
Location:	Henån
Price:	SEK 1 400 000:-

#### **CONSTRUCTION**

##### **Hull & Deck**

White hull with maroon red trim lines

Hull and deck in fiberglass-reinforced polyester in sandwich construction. The surface layer is gelcoat.  
The main bulkheads are laminated to the hull and deck.

##### **Keel & Rudder**

Cast lead keel with a wing at the bottom aft end. (keel bolts checked 2017)

Acid resistant stainless-steel bolts cast in the lead keel

Rudder on a skeg with 2 x bearings

## TECHNICAL SYSTEM

### Engine and propulsion

Volvo Penta MD22 (new heat exchanger 2015) (new alternator 2014 and new belt 2017)

Fixed 3-bladed propeller (2017)

Propeller shaft with rope cutter

Sidepower bowthruster in tunnel

### Tanks

Fuel approx. 275 lit. (cleaned 2018)

Water approx. 450 lit. (cleaned 2017)

Holding tank with deck and sea evacuation

Hot water boiler 22 lit.

### Pumps

Electric bilge pump

Manual bilge pump

Shower waste pump

Fresh water pump (2016)

### Electrical system

220V shore power system with battery charger

220V outlets in galley and toilet

Engine alternator 12V/ 65 A

Battery in stb.sofa aft – Tudor Dual, 12V/ 115Ah

2 x Service batteries in lowest step at the stair – Varta 12V/ 140Ah (2019)

Starter battery in lowest step at the stair – Tudor Dual, 12V/ 95 Ah (2018)

### Navigation system

Compass, with light

Plotter at the pedestal Raymarine

Hand held VHF at pedestal

5 x Raymarine instrument above sliding hatch (Wind and multi i70 – 2018)

Plotter in cockpit to port side of sliding hatch (Navpod)

Autopilot (new control unit 2021)

At nav-table below deck:

2 x Raymarine instruments

VHF Raymarine

### Hi-Fi

Stereo/CD with radio – Pioneer (2015)

Speakers in saloon and cockpit

## Various technical equipment

Diesel heaters with outlets in aft and fwd cabins, saloon and toilet – Eberspächer (2018)

Fridge, Isotherm (2015)

Cooker, ENO (2014)

2 x gas bottles (in deck locker to stb.side)

## INTERIOR

### General

Layout: Forward and aft cabins saloon, navigation area, galley, toilet and separate shower

Handmade interior of selected mahogany

Headlining of creme white covered panels

New upholstery and mattresses (2016)

New carpets (2014)

### Interior layout

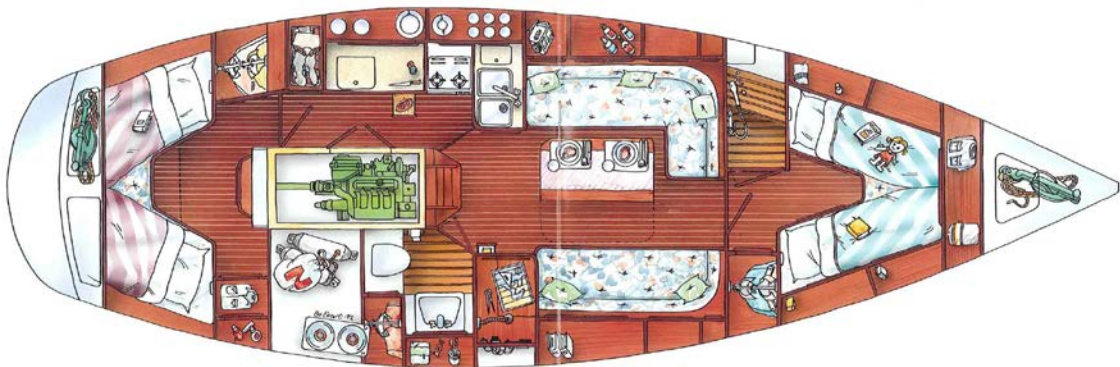

## DECK EQUIPMENT

### Rig

Hydraulic in-mast Furling – operated from the cockpit

Manual Furlex for Genoa – Seldén

Rod kicker with gas damper

Manual back stay tensioner

Stainless steel turnbuckles

Aluminium rigging screw protections

Telescopic spinnaker boom

Halyards and sheet (2017)

### Sails

Furling main sail

Furling genoa (2018), cover (2016)

Working jib (2016)

### **Winches**

2 x manual Genoa winches - Andersen 52 ST  
2 x additional sheet winches - Andersen 40 ST  
1 x halyard winch to stb.side of the sliding hatch behind the windscreen - Andersen

### **Mooring equipment**

4 x cleats stainless steel  
2 x spring cleats stainless steel  
4 x mooring lines  
4 x fenders  
Stainless steel protection rails at the cleats and gateways

### **Anchor system**

Bow - Electric windlass – Lofrans  
Stainless steel anchor (Bruce type) and stainless steel chain

### **Skylights, Windows**

3 x skylights (fwd and aft cabin and saloon)  
Fixed Windscreen  
2 x grab rails (stainless steel) at the windscreen

### **Teak**

Solid teak on deck, coach roof and in cockpit area  
Teak on deck new (2017)

### **Cockpit**

Sprayhood and Sprayhood extension (cleaned and impregnation against mold 2018)  
Steering wheel, foldable (2017)  
High gloss varnished entrance  
Cockpit locker

### **Various deck equipment**

Special type of bow ladder (2014)  
Gates to both sides  
Stainless steel pushpit with integrated (G&T) teak seats  
Bolted on swimming platform to the transom  
Swim/safety ladder at the platform  
2 x deck lockers to aft deck  
Outlets in cockpit for hot and cold water

### **Annual maintenance**

We at Berthon Scandinavia has had the opportunity to get information from Orust Yacht Service about their annual maintenance of this yacht. Of notes from 2014 until today, we can state that a thorough service, inspection and upgrade of the yacht have been performed annually.

## **Reservations**

Berthon Scandinavia has summarized information from the seller and Orust Yacht Service regarding the yacht and the equipment in this document. When establishing specifications, errors can occur, such as misunderstandings or printing errors. The buyer is responsible for inspecting and verifying that the information in this specification is correct. We therefor recommend and encourage the buyer to check the yacht and the equipment by himself and to hire an authorized surveyor to verify this specification and the yacht's general condition.

For further information and booking of viewing please contact:

Berthon Scandinavia

+46 (0)304 69 40 00

[info@berthonscandinavia.se](mailto:info@berthonscandinavia.se)

[www.berthonscandinavia.se](http://www.berthonscandinavia.se)