



## **Najad 440 / 2008**

Detailed specification

### **DATA**

LOA:	13,5 m
Year:	2008
LWL:	12,1
Beam:	4,03 m
Draft:	2,10 m
Displacement:	14 ton
Hull material:	GRP composite
Engine:	Volvo D2-75
Designer:	Najad AB/ Judel/Vrolijk
Builder:	Najad AB, Sweden
Location:	Henån, Sweden
Price:	€ 319 000
VAT:	Paid EU

### **BROKERS COMMENT'S**

The aim for the successful design of the Najad 440 was to create a luxury, highly exclusive and superb sailing yacht, capable of being handled comfortably, effectively and safely by a crew of one or two persons.

The outcome from the combination of naval architect Judel/Vrolijk & Co, interior designer Rhodes Young and Najadvarvets craftsmen, was a ground-breaking, exceptional 'world class' yacht. Najad 440 is equally suited to the ocean adventurer as to the gentler life of coastal cruising and island hopping.

Najad 440 comes in two different versions, AC (aft cockpit) and CC (center cockpit). This Najad 440 FLYING PENGUIN is an CC version that was delivered in 2008. This means it offers well protected cockpit ideal for ocean sailing where all sailhandling and instruments are always close to you. The sprayhood and cockpit tent offers good protection also in cold climate sailing conditions.

The interior layout offers a large owners aft cabin with double berths and a suite toilet with shower. The forward guest cabin also offers a double berth, a suite toilet with shower and plenty of storage space. A large gally is

located to port of the entrance extending aft wards and the navigation table with a comfortable seat is located directly to starboard of the entrance. The saloon has a C-sofa to port and two seats to starboard. A superb layout for an ocean going yacht!

The interior is made of selected mahogany with floorboards in Jatoba and blue coloured upholstery.

At the moment FLYING PENGUIN is on route from Caribbean to Europe on board a freight ship. The yacht is planned to arrive in Germany in the beginning of June and should be in Henån, at Berthon Scandinavia's showing dock, around beginning of July!

## OWNERS COMMENT'S

We bought the yacht in Fort Lauderdale 2017 from the first Swedish owner and had it shipped to Sweden in the autumn of 2017. During 2018 we made a general upgrade in order to have the best modern equipment for our sailing trip and stay in the Caribbean. We have been sailing this area of the world and had a fantastic time onboard, now for almost 2 years. FLYING PENGUIN will soon be shipped back to Europe and be available at Berthon Scandinavia's showing dock in Henån from approx. end of June 2021. Now the FLYING PENGUIN is set for the next owner and looking forward to new adventures.

## KEY FACT'S

- Epoxy treatment - 2020
- Sail drive and sail drive seal - 2017
- Generator (Whisper 3600)
- 4 x Solar panels 360 W - 2019
- All Raymarine instrument - 2017-2019
- Stereo and TV - 2019
- 2 x Electrical toilet
- Gas stove, 2 burners with oven and grill Force 10 - 2017
- Upholstery - 2019
- Topping mattresses for all beds - 2019
- In-mast Furling (Seldén)
- 2 x Furlex for Genua and Jib (Seldén)
- Hydraulic boom vang and aft stay tensioner, manoeuvred from cockpit
- Standing rigging inspection - 2019
- All halyards and sheets - 2019
- Main sail, Genua, Jib - 2016
- 3 x Electric winches

## CONSTRUCTION

### RCD Status

The yacht conforms with the essential safety requirements of A-Unlimited Ocean voyages and is categorised A – "Ocean"

### Hull, Deck & Superstructure

White hull with red trim lines

Hull in sandwich construction with divynycell core material. The surface layer is gelcoat

Deck in sandwich construction with divynycell core material. The surface layer is gelcoat

The hull and deck are reinforced in exposed areas

The main bulkheads are laminated to the hull and deck

Epoxy treatment - 2020

### Keel & Rudder

Cast iron keel with lead bulb

Acid resistant stainless-steel bolts

Spade rudder with 2 x bearings including lower spheric bearing

Service of steering system – 2021 (new bearing)

## **TECHNICAL SYSTEM**

### **Engine and propulsion**

Bow thruster  
Volvo Penta D2-75 approx. 5700 hrs  
Engine serviced every 500 hrs  
New turbo / exhaust elbow at 3950 hrs - 2015  
3 blade folding-propeller  
Sail drive and sail drive seal - 2017

### **Tanks**

Fuel approx. 425 L (stainless steel tanks)  
Water approx. 522 L (stainless steel tanks)  
2 x Holding tanks approx. 120 L (stainless steel tanks) deck and sea evacuation  
Hot water boiler 40 L Isotherm - 2021

### **Pumps**

Electric emergency pump  
Manual bilge pump  
2 x Shower pump (one from - 2019)  
Fresh water pump

### **Electrical system**

220 V shore power system, 220 V outlets in all cabins, ground fault circuit breakers, fuse box and shore cable  
Insulation transformer (Victron 3600)  
Combi charger / inverter 24V / 60A / 2000 W (Mastervolt)  
Regulator for solar panels (Mastervolt) - 2019  
2 x Engine alternators  
6 x Service batteries (GEL) 6 x100 A / 600 Ah - 2017  
Start battery 75Ah - 2017  
Generator (Whisper 3600), 1848 hrs, cooling water pump - 2021, stop solenoid - 2019  
4 x Solar panels 360W - 2019

### **Navigations system**

Analog Compass (Plastimo) - 2019  
Multi Instruments i70 (Raymarine) - 2017  
Wind instrument i69 (Raymarine) - 2017  
Autopilot (Raymarine p70s Evolution) - 2019  
Drive unit autopilot (Lewmar) - 2019  
Wireless remote-control for the autopilot - 2019  
Plotter / Radar display 12 tum (Raymarine Axiom) at navigation table - 2019  
Plotter / Radar display 9 tum (Raymarine Axiom) at pedestal - 2019  
Radar antenna (Raymarine Quantum) - 2019  
AIS transceiver (Trueheading)  
VHF 2 station in cockpit and at navigation table (Raymarine RAY 90/91) - 2019  
2 x VHF speaker  
Mast head combi antenna for VHF, FM/AM  
Tri colour light with light for Windex - 2017  
PEPWAVE network - 2019

## Hi-Fi / IT

2x Stereo/CD with radio (Pioneer Bluetooth) - 2019

Speakers in saloon and cockpit

Cockpit speakers (West Marine) - 2021

TV 32 tum (LG) - 2019

## Various technical equipment

Diesel heater (Eberspracher) outlets in all cabins and heads (renovated - 2019)

2 x Gas bottles

3 x Fire extinguisher

Foghorn with speaker function

## INTERIOR

### General

Layout: Sleep 4 persons in 2 cabins with double berth, galley, 2 x heads / shower, saloon and navigation area

Handmade interior of selected African mahogany

Floor boards in varnished dark wood with inlaid stripes

Inspection hatches in floorboards

Headlining of creme white covered panels

Plenty of storage space in shelves, cabinets and closets

Good ventilation

**Layout (NB! there are two seats with a table to starboard in the saloon)**

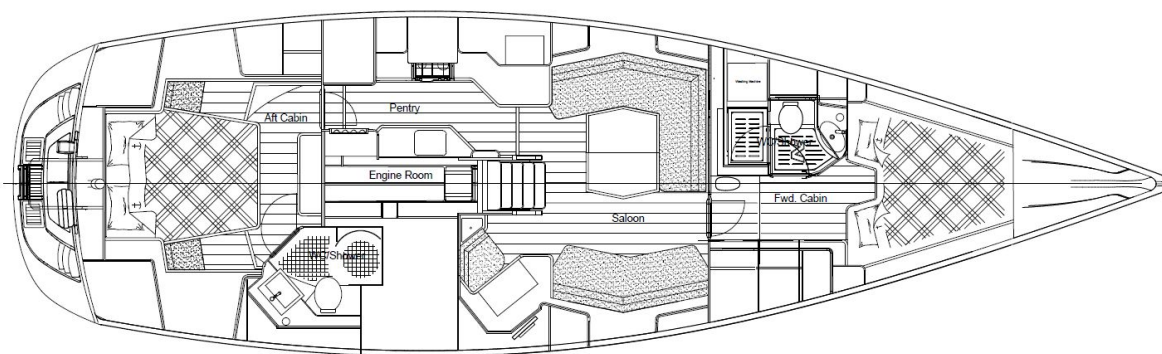

### Forward cabin

Forward cabin there is a full width double berth and a wardrobe on the starboard side with spacious cupboards underneath. There is a large stowage facility underneath the berth. An opening skylight can be used as an emergency exit or for ventilation purpose. A heads/shower is located directly to port within the area of the forward cabin

### Forward Heads / Shower

Light and spacious. Built with white laminated bulkheads including wash basin, bench surface and shower floor made of Kerock® material. Electrical toilet - 2019. Mirror.

### Saloon

Exclusive entrance stairs with shaped footsteps and stainless steel handrail covered with leather. A foldable table with a locker for bottles. Sofas to PT and 2 chairs to SB, plenty of cabinets and book shelves

## Navigation area

Navigations area to starboard of the entrance stairs. Large navigation table, drawers, comfortable seat, space for instruments

## Galley

The galley is located to PT of the entrance stair, extending aft wards. Plenty of storage spaces, cupboards, drawers, dry storage and shelves.

Kerock® worktop with twin sinks and a chopping board over one sink

Gas stove, 2 burners with oven and grill Force 10 - 2017

Gas valve remote control

Micro wave

Fridge with 92 L (Isotherm)

Freezer/Fridge 41 L (Isotherm)

## Aft cabin (Owners cabin)

A passageway on the port leads to the aft cabin, which includes a wide double berth amidships and sufficient stowage for extended periods at sea. Seats on each side of the berth. Spot lights and reading lights positioned for comfortable reading. The bed base is unvarnished and ventilated with holes to minimise dampness. Two fixed portholes in the hull and two openable skylights for ventilation. Heads/shower is located to starboard with entrance from the aft cabin

## Aft Heads / Shower

Light and very spacious. Built with white laminated bulkheads including wash basin, bench surface and shower floor made of Kerock® material. Electric Toilet. Mirror.

## Various interior details

Ceiling and reading lights LED partly with dimmers

SKY sol blinds for portlights in the saloon incl. vinyl covered coaming

Sky screens at all skylights

New fabric 2 cabins and saloon (in the whole boat) - 2019

Topping mattresses for all beds - 2019

## DECK EQUIPMENT

### Rig

In-mast Furling (Seldén)

2 x Furler for Genua and Jib (Seldén)

Hydraulic boom vang and aft stay tensioner, manoeuvred from cockpit

Stainless steel turnbuckles

Aluminium rigging screw protection

Deck lights in front of mast

Steaming and anchor lights

Flag halyards

Windex

All halyard and sheets - 2019

Standing rig controlled of Ship Shape (Bullandö) - 2019

### Sails

Furling main sail (Dacron) US Ullman sails - 2016

Furling working jib (Dacron) US Ullman sails - 2016

Furling Genoa (Dacron) Syversen - 2019

Gennaker with snuffer approx. 130 m<sup>2</sup> - 2010

## Winches

2 x Electrical Genua winches (Andersen 58 STE)  
1 x Electrical Winch (Andersen 46 STE), new gearbox - 2020  
1 x Manual Winch (Andersen 46 ST)

## Mooring equipment

4 x Cleats stainless steel  
4 x Spring cleats stainless steel  
6 x Mooring lines  
6 x Fenders - 2019  
Stainless steel protection rails at the cleats and gateways  
Lifelines gates

## Anchor system

Electric windlass (Lofrans) in bow with remote control, Vulcan 25kg, 80 m x 12 mm stainless steel chain - 2020  
Chain counter Lofrans - 2019  
Electric windlass in stern (Sidepower) with remote control, 20 kg anchor, 50 m lead line - 2019

## Skylights, Portlights, Windows

Skylights, flush mounted  
Portlights in coach roof, openable in forward heads and forward cabin  
6 x Deck ventilators  
Fixed Windscreen (stainless steel frame)  
2 x grab rails (stainless steel) at the windscreen  
Ventilation louvers in the companionway hatch

## Teak

Solid teak on deck, coach roof, swim platform and in cockpit area  
Teak capping with stainless steel protection rail

## Cockpit

Sprayhood and Sprayhood extension  
Bimini with stainless steel frame  
Steering wheel foldable, stainless steel, hide covered  
Canvas covers for winches  
Cockpit cushions  
High gloss varnished entrance  
Varnished cockpit table  
Stainless steel grab rail at the pedestal  
2 x Grab rail at entrance  
Cockpit locker

## Various deck equipment

Targa arch with integrated davits, solar panels and antennas  
Gangway  
Danbuoy (Plastimo) - 2019  
Life raft 6 persons Plastimo - 2019  
EPIRB Mcmurdo (updated tested and new battery - 2019)  
Deck light aft deck - 2019  
Pushpit teak fitting for

Stainless steel pushpit with integrated (G&T) teak seats

Flag pole

Shower at swim platform

Swim/safety ladder

Bow ladder in cassette - 2017

### **Reservations**

Berthon Scandinavia has summarized information from the seller regarding the yacht and the equipment in this document. When establishing specifications, errors can occur, such as misunderstandings or printing errors. The buyer is responsible for inspecting and verifying that the information in this specification is correct. We therefore recommend and encourage the buyer to check the yacht and the equipment by himself and to hire an authorized surveyor to verify this specification and the yacht's general condition.

### **For further information and booking of viewing please contact:**

Magnus Kullberg

+46 79 079 55 45

[magnus.kullberg@berthonscandinavia.se](mailto:magnus.kullberg@berthonscandinavia.se)

[www.berthonscandinavia.se](http://www.berthonscandinavia.se)