



## Hallberg-Rassy 45 / 1993

### Detailed Specification

#### DATA

Length:	14,12 m
Year:	1993
LWL:	11,60 m
Width:	4,32 m
Draft:	1,88 m
Displacement:	16.000 kg
Material:	GRP
Engine:	Volvo Penta TMD 31 95 hp
Designer:	Germán Frers
Manufacturer:	Hallberg-Rassy AB
Location:	Svineviken, Orust
Price:	EUR 239.000 (VAT paid)

#### DESCRIPTION

Hallberg-Rassy 45 quickly became a trendsetter when it was launched in 1988. A total of 71 boats were built between 1988 to 1996. This was the first model designed by Germán Frers and we must admit that it was a huge success. Not only the design was new and innovative, this was also the first time when Divinycell was used as an insulated material for the hull. This model has also an external lead keel and sturdy hull stiffener along and cross the boat. The Hallberg-Rassy 45 is the perfect blue water cruiser, the combination of good sailing performance and the comfort onboard is something you will appreciate. This is a yacht you can live on.

This Hallberg-Rassy 45 is a first owner yacht, and she is in an excellent condition. The yacht can be seen in Svineviken at Orust.

## Owner's comment

**Hallberg-Rassy 45 Tukan** is in very good condition, all maintenance and service work are carried out by Br. Martinsson Varvs AB. **Tukan** has been in winter storage in a hall 7 months every year since 1993, and in the water for the remaining 5 months. The teak deck is oiled every year which leads to a very nice surface with little wear.

## KEY FACT'S

- Furling mast with 3 pairs of spreaders
- 7 berths in three cabins
- Owner's cabin with separate head/ shower
- Mahogany interior satin varnished, what else...
- Electric anchor winch in the bow and stern
- Bow thruster
- Volvo TMD31A, 95hp. Only 3200 hours
- Diesel generator, Westerbeke
- Teak deck
- Complete navigation system with radar, Raymarine/ Autohelm
- Draft 1,88m

## CONSTRUCTION

### Hull & Deck

White hull with blue trim lines

Hull and deck in GRP, sandwich construction with Divinycell core

### Keel & Rudder

Bulbed lead keel, deep bilge

Balanced spade rudder

## TECHNICAL SYSTEMS

### Engine and Propulsion

Volvo Penta TMD31A, 95hp approx. 3.300 hours

Shaft drive

Maxprop, 3 blade

Bow thruster, hydraulic

### Tanks

Diesel 600 L (2 x stainless steel)

Fresh water 1000 L (4 x stainless steel)

Holding tank approx. 50 L, deck and sea evacuation (stainless steel) - 2015

Hot water approx. 30 L

### Electric systems

220 V shore power system with earth fault breaker

24 V service batteries 280 Ah - 2014

12 V start battery

Battery charger 24V/25A

Battery charger 12V/20A

DC control panel with automatic circuit breakers

Diesel generator 4kW (Westerbeke), approx. 350 hours

## Navigation

1 x Compass with light  
Plotter in cockpit at chart table (Raymarine CW 120) - 2011  
Plotter in nav area (Raymarine 620 / 630) - 2000  
Autopilot (Simrad AP26) - 2002  
Radar (Raymarine R21X)  
1 x Wind instrument (Autohelm ST50)  
1 x Depth instrument (Autohelm ST50)  
1 x Speed instrument (Autohelm ST50)  
1 x Multi instrument in nav (Autohelm ST50)  
1 x Compass EI (Autohelm ST50)  
1 x VMG Wind (Autohelm ST50)  
VHF (Shipmate 8100), operated from nav table incl loudspeaker  
VHF Antenna CX4  
Fastnet radio GMDSS Recorder FMD 55 -1996  
Windex  
Antenna TV / Radio FM (Glomex)  
Isolated backstay

## Hi-Fi

Radio/CD, 2 x speakers in salon and cockpit

## Various technical equipment

2 x Diesel heater (Webasto), outlets in all cabins, heads, and cockpit  
2 x Gas bottle 5kg  
Fire extinguishers  
Manual bilge pump  
Electric bilge pump

## INSIDE

### General

Interior in varnished mahogany in satin finish  
Sleep 7 persons in owner's cabin and 2 x guest cabin  
Owners cabin with separate head/ shower  
2 x heads  
L-sofa port and two armchairs starboard  
Navigation area port side  
U-shape Galley starboard side  
White ceiling

## Layout

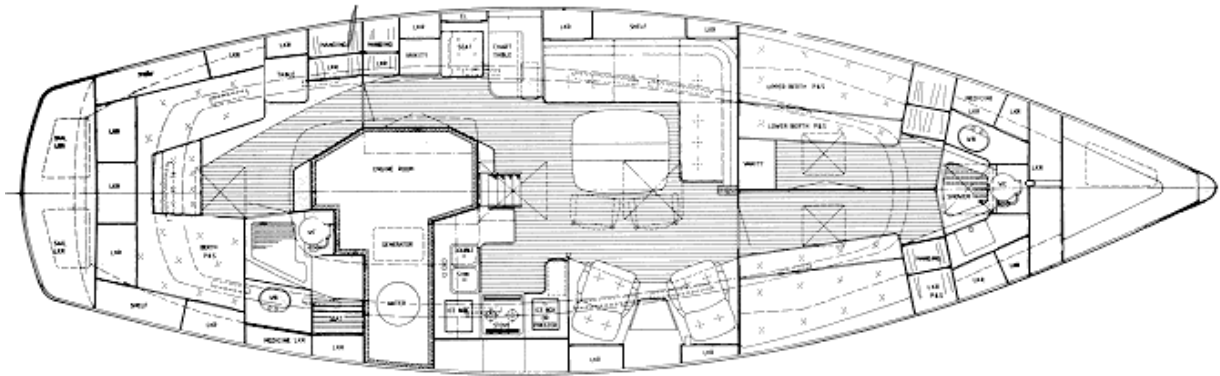

### 2 x Forward cabin

- Guest cabins with bunk beds
- Cupboards and wardrobe
- Skylight and portlight with curtain

### Forward head

- Spacious head with separate shower
- Skylight
- Teak floor grating
- Washing machine in locker

### Saloon

- Spacious saloon with L-sofa and foldable table, for 6-8 persons
- Armchairs, cocktail cabinet between
- Amplify with cupboards and storage
- 1 x Folding chair
- Bookshelves
- Skylight with curtain
- Port lights in deck, all with curtains
- Grab handles
- Electric radiator

### Navigation area

- Navigation area on port side, facing forward
- Seat, chart table and drawers for equipment
- Bookshelf and cupboards

### Kitchen

- U-shape functional galley on starboard side of entrance, aft in the saloon
- White worktop
- Cupboards, drawers and shelves for storage
- Sliding plexi doors
- Stove with 3 burners and oven
- 2 x Fridge
- Double sink with water tap
- Gas remote switch
- Hot & cold pressure water

Sea water pump

**Owner's cabin**

Large aft cabin with double berth stb, seat, single berth port side  
Plenty of storage, cupboards, lockers and drawers  
Skylight and port lights with curtain  
Electric radiator

**Aft head**

Spacious head with toilet and separate shower  
Port light with curtain  
Large mirror  
Sink and lockers outboard  
Teak floor grating

**Interior details**

Ship clock & barometer  
Reading lights  
Floorboards varnished  
Carpets in all cabins

**DECK**

**Rig**

Masthead furling mast, 3 pair spreaders (Selden)  
In-mast furling system operated from the mast  
Removable cutter stay and running backstays  
Baby stay  
Furlex for genua (Selden) with separate electric winch  
Rodkick  
3-color and anchor light in mast top  
Deck light  
2 x jib halyard with stopper  
Spinnaker sheet with block

**Sail**

Main sail (Elvström) - 2002  
Genoa (Elvström) - 2002  
Cover for Genua, blue  
Jib for cutter stay  
Blister (down wind sail) - original, lightly used.

**Winches**

2 x Winch 66ST 2-speed (Lewmar)  
2 x Winch 44ST 2-speed (Lewmar)  
2 x Winch 44ST 2-speed on mast (Lewmar)  
1 x Winch 8 on mast

### **Mooring equipment**

4 x Mooring cleats, aluminium  
2 x Spring cleats, aluminium  
4 x Mooring lines  
6 x Fenders

### **Anchor system**

Bow: Electric windlass 24V, CQR anchor with 10mm chain  
Stainless steel bow fitting with anchor roller  
Stern: Electric windlass 24V, anchor and chain - 1996  
Stern: Stainless steel Delta anchor with lead line - 2015

### **Skylights, Portlights, Windows**

5 x Skylights  
10 x Portlights  
4 x Portlights fixed

### **Teak**

Teak on deck, cockpit and hard top roof

### **Cockpit**

Windscreen with hard top  
Steering wheel with elk skin  
Cockpit table  
Canopy for cockpit - 2010  
Cockpit locker  
High gloss varnished companion way and chart tables

### **Various deck equipment**

Lifeline gates, port and starboard side  
Cockpit shower, warm and cold water  
G&T seats on aft pulpit  
Safety/ swim ladder  
Life raft 6 pers, service needed  
Bow ladder  
7 x Dorade vents on deck  
Dinghy and outboard engine (Pischel/Bolero with Mercury 5hp)  
Bracket for outboard engine on pushpit

### **Reservation**

Berthon Scandinavia has summarized information from the seller regarding the yacht and the equipment in this document. When establishing specifications, errors can occur, such as misunderstandings or printing errors. The buyer is responsible for inspecting and verifying that the information in this specification is correct. We therefore recommend and encourage the buyer to check the yacht and the equipment by himself and to hire an authorized surveyor to verify this specification and the yacht's general condition.

### **For more information and booking of viewings**

Magnus Kullberg  
+46 79 079 55 45  
[info@berthonscandinavia.se](mailto:info@berthonscandinavia.se)  
[www.berthonscandinavia.se](http://www.berthonscandinavia.se)



# BERTHON

SCANDINAVIA

