



MUCHACHA II

LOA:	38' / 11.58m
Year:	2015
LWL:	34' / 10.36m
Beam:	12'2" / 3.70m
Draft:	7'10" / 2.40m
Displacement:	6,775kg / 14,936lb
Hull Material:	GRP
Engines:	Yanmar 29 hp
Designer:	X-Yachts Design
Accommodation:	8 berths in 3 cabins and saloon
Builder:	X-Yachts
Location:	Kolviken, Värmdö - Sweden
Price:	SEK3,450,000 incl. VAT

BERTHON

INTERNATIONAL YACHT BROKERS

Ängsvägen 16, 473 33 Henån

T: +46 304 694 000

E: brokers@berthonscandinavia.se

W: www.berthonscandinavia.com

Disclaimer

These particulars have been prepared from information provided by the vendors and are intended as a general guide to the yacht, their accuracy cannot be guaranteed by us. The purchaser should confirm details of concern to them by survey or engineer's inspection. The purchaser should also ensure that the purchase contract properly reflects their concerns and specifies details on which they may wish to rely.

Broker's Comments:

X-Yachts have always been associated with fast sailing boats - with high quality and stylish design. The characteristic lines leave no sailor untouched and with the Xperformance series they have taken it to another new level. The X-Yachts Xp 38 model was introduced to the market in 2011 and has reaped success on both IRC and ORC races. The term performance cruiser-racer gives a clear picture of the unsurpassed performance she delivers.

Thanks to high stability, low weight and easy handling, it makes her not only a fast race boat but also an uncompromising and comfortable luxury yacht to sail on your holiday. The hull and deck are made with vacuum injected epoxy technology and she has been equipped with a carbon fiber mast and boom. This yacht has an incomparable sail wardrobe, one that you can easily trim from the spacious cockpit. Two steering wheels give you both a nice passage and an unbeatable overview of the deck. Under deck, you are greeted by a modern saloon with bright and practical kitchen. Three cabins with six beds provide plenty of space for the whole family.

X-Yachts Xp 38 MUCHACHA II has only had one owner and has mainly been used for regatta sailing. She is in excellent condition and the owner has not saved on anything to optimize this performance yacht. If you are looking for a wonderful sailing experience, you will not be disappointed.

Key Facts:

- Carbon fibre mast and boom (Southern Spars).
- Rod rig.
- Mast jack system.
- Complete race set of sails (North Sails).
- Race optimized for ORCi, GPH 579,8 (2019).
- Rudder in carbon fibre.
- Deep draft T-keel, weight optimized.
- Top finish at the bottom, new VC-17 antifouling - 2020.
- B&G H5000 navigation equipment.
- Not used much for cruising.
- Lithium batteries.
- Heater.
- Red night lightning in the saloon.

Owner's Comments:

X-Yachts Xp 38 MUCHACHA II is built to be a fast boat and participate in races in the classes ORC international and SRS. Over the years, I have successfully completed the offshore races Gotland Runt, Åland Offshore race, Lidingö Runt etc. GPH about 580, SRS 1,127 depending on the choice of sail.

During her few years, she has been very sparingly used for cruising as I have another boat for this purpose. She has also rested a lot on land the last two seasons due to the COVID-19 pandemic. With increasing age, the captain has decided to allow for more cruiser sailing on-board his new (larger) boat in the future and therefore MUCHACHA II is now for sale. If you have the ambition to participate at the highest level in fleet, club and offshore racing, or are just looking for a fast but still comfortable boat, then you have a unique specimen here.

Disclaimer

These particulars have been prepared from information provided by the vendors and are intended as a general guide to the yacht, their accuracy cannot be guaranteed by us. The purchaser should confirm details of concern to them by survey or engineer's inspection. The purchaser should also ensure that the purchase contract properly reflects their concerns and specifies details on which they may wish to rely.

Construction:

RCD Status: The yacht conforms with the essential safety requirements of Directive 94/25EC or RCDII (2013/53/EU as appropriate (Recreational Craft Directive) and is categorised A – “Ocean” (or Cat B – whichever is appropriate)

Hull, Deck & Superstructure Construction:

- White hull with blue trim lines.
- Hull and deck in vacuum injected epoxy, sandwich construction with keel reinforcement in carbon fibre.
- Epoxy treated underwater body, graphite grey antifouling (VC 17) - 2020.
- GRP cowl instead of anchor fitting, ORC racing.
- Teak in cockpit.

Keel & Rudder:

- Deep draft T-keel, racing.
- Iron fin with lead bulb. Weight optimized, lighten approx. 100kg aft edge.
- Balanced rudder in carbon fibre, rudderstock in carbon fibre, white epoxy. Weight 14kg (Std approx. 60kg).
- New heavier rudder bearings.

Machinery:**Engine & Gearboxes:**

- Yanmar, 29hp; 320 hours.
- S-drive.

**Propulsion & Steering:**

- Folding propeller, 2-blade (Flexofold).

Electrical Systems:**Voltage Systems:**

- DC control panel.

Disclaimer

These particulars have been prepared from information provided by the vendors and are intended as a general guide to the yacht, their accuracy cannot be guaranteed by us. The purchaser should confirm details of concern to them by survey or engineer's inspection. The purchaser should also ensure that the purchase contract properly reflects their concerns and specifies details on which they may wish to rely.

Battery Banks:

- 12 V Lithium service battery 160 Ah (Super B).
- 12 V Lithium start battery 15 Ah (Super B).

Battery Chargers:

- Battery charger 12V/25A (Mastervolt).

Alternators:

- Alternator 12V.

Shore Power:

- 220 V shore power system with earth fault breaker.

Other Electrical:

- Galvanic isolator, isolation transformer (Mastervolt).

Plumbing Systems:**Fresh Water & Water Heating System:**

- Hot water 15 L.

Bilge Pumps:

- 2 x Manual bilge pump.
- Electric bilge pump.

Tankage:

- 1 x Gas bottle.

Fuel:

- Total capacity of 175 litres (aluminium); 38.49 gallons.

Fresh water:

- Total capacity of 260 litres (plastic); 57.19 gallons.

Grey/Blackwater holding tanks:

- Total holding tank capacity 1 x 60 litres, deck and sea evacuation (plastic); 13.19 gallons.

Navigation Equipment:

- 1 x Compass with light (Silva).
- B&G H5000 series.
- 2 x H5000 graphic display at companionway.
- 1 x Zeus3 plotter at companionway.
- 1 x Zeus3 plotter at nav table.
- 1 x ZG 100 GPS Antenn.
- 1 x H5000 Hercules CPU processor.
- 1 x Log transponder.
- 1 x Depth transponder.
- 1 x Wind transponder.
- 1 x Go Free Wifi, integrated with B&G system.

Disclaimer

These particulars have been prepared from information provided by the vendors and are intended as a general guide to the yacht, their accuracy cannot be guaranteed by us. The purchaser should confirm details of concern to them by survey or engineer's inspection. The purchaser should also ensure that the purchase contract properly reflects their concerns and specifies details on which they may wish to rely.

- 1 x AIS NAIS 400B, transmit & receive.
- 1 x H5000 grafic display at nav table.
- 4 x 20/20 displays on mast.
- 1 x VHF (Simrad RS90BB).
- 1 x VHF hand set (Simrad HS35).
- 1 x VHF speaker in cockpit (Simrad LS80).
- 1 x H5000 Autopilot AC42N incl. pilot control and HGSC gyro compass.
- 1 x Remote control for autopilot.

Domestic Equipment:*Galley:*

- Stove with 2 burners and oven.
- Double sink with water tap.
- Fridge.

Heads/Shower:

- 1 x WC.
- 1 x Shower.

Heating & Ventilation:

- 1 x Diesel heater incl. 4 outlets (Eberspächer D5).

Entertainment:

- CD/DVD/MP3/USB (AKAI ACA D30B).
- Speaker in cockpit and saloon (Bose).

Lighting:

- LED navigation lights in mast, tricolour with anchor light.
- Red night lightning in saloon.

Accommodation:*Summary of Accommodation:*

- Interior in teak, blue cushions in microfiber.
- 6 berths, owner's cabin + 2 x guest cabin aft.
- Pipe cot berths in aft cabins, sea berths in saloon.
- Heads with shower.
- L-sofa on port side, centerline foldable leaf table.
- Sofa starboard side.
- Movable navigation table on starboard side.
- White inner ceiling with spotlights.
- Generous storage space.
- Teak floor boards in marine plywood.

Disclaimer

These particulars have been prepared from information provided by the vendors and are intended as a general guide to the yacht, their accuracy cannot be guaranteed by us. The purchaser should confirm details of concern to them by survey or engineer's inspection. The purchaser should also ensure that the purchase contract properly reflects their concerns and specifies details on which they may wish to rely.

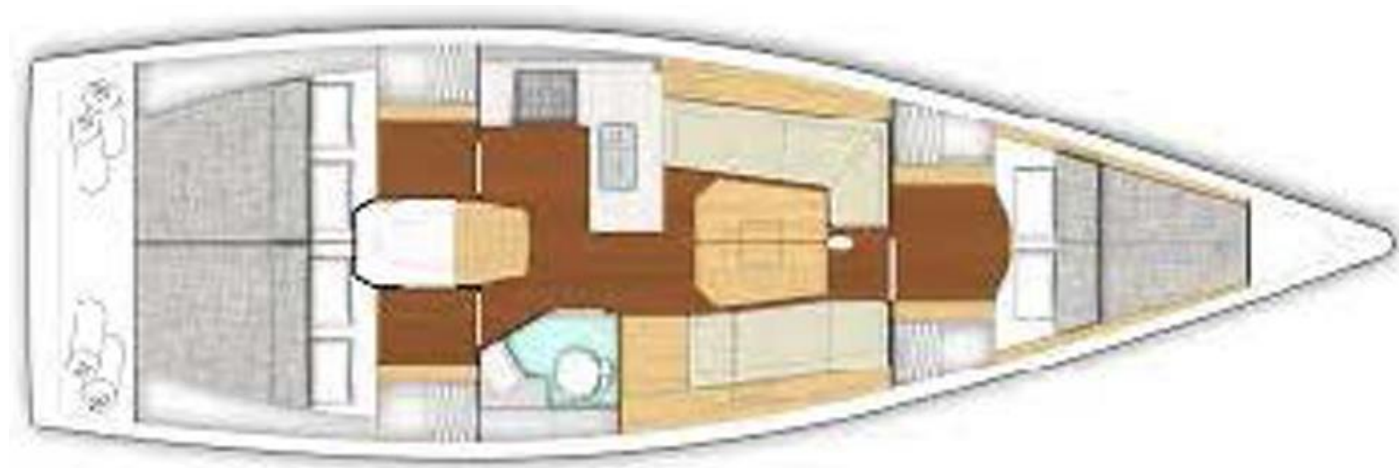
Internal Layout:*Description of layout from forwards:**Forward Cabin (Owner's):*

- Owner's cabin with double berth, storage under bed.
- 2 x Hanging lockers.
- 3 x Skylights.

**Disclaimer**

These particulars have been prepared from information provided by the vendors and are intended as a general guide to the yacht, their accuracy cannot be guaranteed by us. The purchaser should confirm details of concern to them by survey or engineer's inspection. The purchaser should also ensure that the purchase contract properly reflects their concerns and specifies details on which they may wish to rely.

Saloon:

- Spacious saloon with ample of storage.
- Cupboards and bookshelves.
- Drawers in saloon table.
- Skylight.
- Grab handles in stainless steel.
- Portlights and fixed windows.
- Reading lights and spotlights.
- Sea berths on starboard & port side.

**Navigation Area:**

- Navigation table on starboard side, movable facing forward or backward.
- Bookshelf and cupboard.

**Disclaimer**

These particulars have been prepared from information provided by the vendors and are intended as a general guide to the yacht, their accuracy cannot be guaranteed by us. The purchaser should confirm details of concern to them by survey or engineer's inspection. The purchaser should also ensure that the purchase contract properly reflects their concerns and specifies details on which they may wish to rely.

Kitchen:

- L-shape functionally kitchen on port side.
- Kitchen unit in composite.
- Cupboards, drawers and shelves for storage.

**Disclaimer**

These particulars have been prepared from information provided by the vendors and are intended as a general guide to the yacht, their accuracy cannot be guaranteed by us. The purchaser should confirm details of concern to them by survey or engineer's inspection. The purchaser should also ensure that the purchase contract properly reflects their concerns and specifies details on which they may wish to rely.

Aft Head / Shower:

- Head with toilet and shower.
- White bathroom unit.
- Mirror on bulkhead, cupboard under sink.
- Manual toilet.

*Aft Cabin – Port / Starboard:*

- Symmetric aft cabins with double berths.
- Extra pipe cot berths.
- Wardrobe and cupboards.
- Port lights and sky light.

**Disclaimer**

These particulars have been prepared from information provided by the vendors and are intended as a general guide to the yacht, their accuracy cannot be guaranteed by us. The purchaser should confirm details of concern to them by survey or engineer's inspection. The purchaser should also ensure that the purchase contract properly reflects their concerns and specifies details on which they may wish to rely.

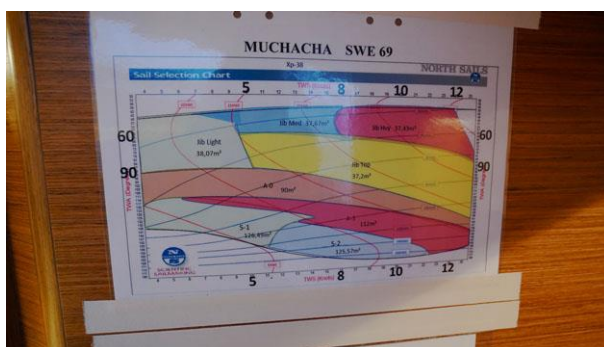
[illegible]

Cockpit:

- Twin steering wheels in composite.
- Cockpit table, new (never used).
- Sprayhood, new (never used).
- Instrument console at companionway, glass fibre.
- Large storage compartment aft and lockers on starboard/port side.

Deck Equipment:

Riq:

- Mast and boom in carbon fiber (Southern Spars).
- Mast jack system, hydraulic.
- Rod rig.
- Luff profile on forestay (Harken).
- Furling system forestay, not fitted (ProFurl).
- Hydraulic backstay tensioner with electric adjustment (Holmatro).
- Spinnaker boom in carbon fiber.
- 1 x Mast head spinnaker halyard.
- 1 x Spinnaker halyard forestay height (pilot line).
- 1 x Main halyard 2:1 SK90.
- 1 x Genoa halyard SK90.
- Halyard and sheet upgraded (Gottifredi Maffioli).

Disclaimer

These particulars have been prepared from information provided by the vendors and are intended as a general guide to the yacht, their accuracy cannot be guaranteed by us. The purchaser should confirm details of concern to them by survey or engineer's inspection. The purchaser should also ensure that the purchase contract properly reflects their concerns and specifies details on which they may wish to rely.

- Rodkick with gas spring.
- Extra race pack for trim, Grand Prix.
- Equipment for spinnaker incl. block, footblock and cam cleats.
- Inhauler for jib, pad eyes, inhauler rings, stoppers.
- Padeyes for toe rail sheet.
- 4 pcs swivel camcleat on coach roof SB & port.
- Barber haul system.

Winches:

- 4 x Winch Genoa / Mainsheet (Harken).
- 2 x Halyard winch, upgrade to 46.2 (Harken).

Sails:

- Main 3Di Aramid/Dyneema 16,800 Dpi (North Sails).
- Main Triesail (North Sails) - 2020.
- Jib Light 3DL Carbon/Aramid 12,600 Dpi (North Sails).
- Jib Medium 3Di Aramid/Dyneema 16,800 Dpi (North Sails).
- Jib Heavy 3Di Aramid/Dyneema 19,600 Dpi (North Sails).
- Jib Heavy Soft NorLam 9.4 NLXG+ (North Sails).
- Jib Hardwindreacher 3DL Aramid 16,800 Dpi (North Sails).
- Jib Windseeker NorLam TF1 3.2 NL (North Sails).
- Staysail NorLam TF1 1.7 NL (North Sails).
- S1 Spinnaker SuperLite/Kote SL 40 CTDR (North Sails).
- S2 Spinnaker SuperLite/Kote SK 60 CTDR (North Sails).
- New S2 Spinnaker SuperLite/Kote SK 60 CTDR (North Sails) - 2020.
- A3 Asymmetric SuperLite/Kote SK 80 CTDR (North Sails).
- A0 Asymmetric SuperLite/Kote SK 130 CTDR (North Sails).

General:

- 6 x Skylights.
- 6 x Portlights.
- 6 x Fixed windows in deck.
- 6 x Fixed windows in the hull.
- Race lifeline stanchions.
- Grab handles on coach roof.
- Safety/swim ladder, stainless steel.
- Centre lift, 8 ton lifting strap with shackle.
- Boom cover.

Anchoring & Mooring Equipment:

- 6 x Mooring cleats, foldable (Nomen cleats).
- 6 x Mooring lines.
- 6 x Fenders.
- Stainless steel 15kg with lead line (Bruce).

Fire-fighting equipment:

- 2 x Fire extinguishers.

Disclaimer

These particulars have been prepared from information provided by the vendors and are intended as a general guide to the yacht, their accuracy cannot be guaranteed by us. The purchaser should confirm details of concern to them by survey or engineer's inspection. The purchaser should also ensure that the purchase contract properly reflects their concerns and specifies details on which they may wish to rely.

**Disclaimer**

These particulars have been prepared from information provided by the vendors and are intended as a general guide to the yacht, their accuracy cannot be guaranteed by us. The purchaser should confirm details of concern to them by survey or engineer's inspection. The purchaser should also ensure that the purchase contract properly reflects their concerns and specifies details on which they may wish to rely.

**Disclaimer**

These particulars have been prepared from information provided by the vendors and are intended as a general guide to the yacht, their accuracy cannot be guaranteed by us. The purchaser should confirm details of concern to them by survey or engineer's inspection. The purchaser should also ensure that the purchase contract properly reflects their concerns and specifies details on which they may wish to rely.

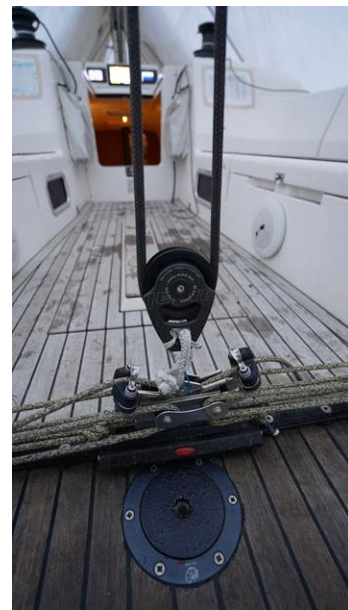
**Disclaimer**

These particulars have been prepared from information provided by the vendors and are intended as a general guide to the yacht, their accuracy cannot be guaranteed by us. The purchaser should confirm details of concern to them by survey or engineer's inspection. The purchaser should also ensure that the purchase contract properly reflects their concerns and specifies details on which they may wish to rely.

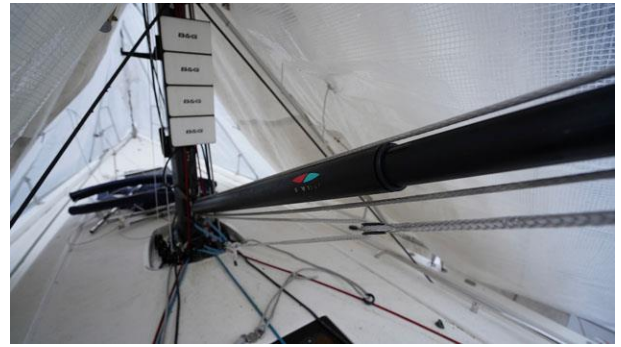
**Disclaimer**

These particulars have been prepared from information provided by the vendors and are intended as a general guide to the yacht, their accuracy cannot be guaranteed by us. The purchaser should confirm details of concern to them by survey or engineer's inspection. The purchaser should also ensure that the purchase contract properly reflects their concerns and specifies details on which they may wish to rely.