



ALCA

LOA:	30'11" / 9.42m
Year:	2020
LWL:	28'10" / 8.8m
Beam:	10'5" / 3.18m
Draft:	5'11" / 1.80m
Displacement:	4,350kg / 9,592lb
Hull Material:	GRP
Engines:	1 x Volvo Penta D1-20
Designer:	Germán Frers
Accommodation:	6 berths in 2 cabins & saloon
Builder:	Hallberg-Rassy AB
Location:	Vindön, Orust - Sweden
Price:	€195,000 VAT paid

BERTHON

INTERNATIONAL YACHT BROKERS

Ängsvägen 16, 473 33 Henån

T: +46 304 694 000

E: brokers@berthonscandinavia.se

W: www.berthonscandinavia.com

Disclaimer

These particulars have been prepared from information provided by the vendors and are intended as a general guide to the yacht, their accuracy cannot be guaranteed by us. The purchaser should confirm details of concern to them by survey or engineer's inspection. The purchaser should also ensure that the purchase contract properly reflects their concerns and specifies details on which they may wish to rely.

Broker's Comments:

This Hallberg-Rassy 310, ALCA, has had only one owner and has been sparingly used for three seasons. She has sailed a total of 3 months along the Swedish and Norwegian coasts. The owner has spared no expense, and ALCA has a high level of equipment, including lithium batteries, radar, plotter, laminate sails, and a gennaker with a furling system. ALCA has been meticulously maintained by her owner and serviced by Vindö Marin, where she has also been stored indoors during the winter. This is truly a boat in excellent condition, she looks like new, ready to explore the world with a new crew!

Key Facts:

- Conventional rig from Selden Mast.
- Laminate sails from Elvström.
- Boom with stack pack and lazy jack system.
- Volvo Penta D1-20 engine.
- Tiller steering.
- Lithium batteries.
- Autopilot on rudderstock.
- Bowsprit for gennaker.
- Sprayhood with extension for cockpit.
- Bathing platform with teak.
- Teak in cockpit.
- Raymarine navigation equipment.
- Radar.
- 6 berths in 2 cabins + saloon.
- Heater.
- Professionell service and maintenance.
- Winter stored indoor.
- Boat in as new condition.

Manufacturer's Comments:

Hallberg-Rassy 310 is an elegant, fast, and easily maneuverable cruiser. The collaboration between Germán Frers and Hallberg-Rassy has been highly successful, resulting in a boat with beautiful hull lines and a modern sail plan. As a result, 132 boats have been produced at the renowned yard in Ellös. This is truly a true Hallberg-Rassy model with all the typical details found on their larger models, such as a windshield, integrated rubbing strake, teak toe rail, and lead keel. The teak in the cockpit and on the bathing platform is vacuum glued. Everything is packaged very tastefully in these 31 feet, a dream boat within reach!

The layout offers accommodation for up to 6 people, spread across two cabins and convertible sofas in the salon. The interior is made of light mahogany, which, combined with good natural light, gives a surprisingly spacious feeling when you step into the boat. Directly to starboard at the foot of the companionway is the galley with ample storage, a stove with an oven, and a compressor-driven refrigerator. Both the aft and forward cabins are generous in size and offer double berths and storage space. In the salon, there is a table with folding sides and two sofas, and a protective mat covers the floor. The toilet is bright, spacious, and comes with a Corian countertop. There are 10 portlights and 4 deck hatches on the boat, all of which are openable and provide excellent ventilation on board.

The cockpit offers plenty of space for everyone on board, and through the opening at the stern, you can easily access the bathing platform, which can be closed off if needed. Hallberg-Rassy 310 is not only a beautiful boat with generous spaces, both below deck and in the cockpit, but she is also a proven good performer and has won her class in the world's largest sailing race, Tjörn Runt.

Disclaimer

These particulars have been prepared from information provided by the vendors and are intended as a general guide to the yacht, their accuracy cannot be guaranteed by us. The purchaser should confirm details of concern to them by survey or engineer's inspection. The purchaser should also ensure that the purchase contract properly reflects their concerns and specifies details on which they may wish to rely.

Construction:

RCD Status: The yacht conforms with the essential safety requirements of Directive 94/25EC or RCDII (2013/53/EU as appropriate (Recreational Craft Directive) and is categorised A – “Ocean” (or Cat B – whichever is appropriate).

Hull, Deck & Superstructure Construction:

- White hull with blue trim lines.
- Hull and deck in GRP, sandwich construction.
- Integrated rubbing strake, stainless steel stripe.
- Teak toerail.
- Windscreen.
- Teak in cockpit and bathing platform.

Keel & Rudder:

- Fin keel with bulb, lead.
- GRP rudder with stainless steel rudderstock and self-aligning bearings.
- Tiller steering.

Machinery:**Engine & Gearboxes:**

- 1 x Volvo Penta D1-20, 19hp.
- Sail drive.

**Maintenance & Performance:**

- Engine hours – approx 144 hours as of June 2023.

Propulsion & Steering:

- Spinlock tiller extension.
- 3-blade Flexofold folding propeller.

**Disclaimer**

These particulars have been prepared from information provided by the vendors and are intended as a general guide to the yacht, their accuracy cannot be guaranteed by us. The purchaser should confirm details of concern to them by survey or engineer's inspection. The purchaser should also ensure that the purchase contract properly reflects their concerns and specifies details on which they may wish to rely.

Electrical Systems:*Voltage Systems:*

- 220 V shore power system with earth fault breaker.

Battery Banks:

- 2 x 12 V Lithium service battery 360 Ah (Mastervolt).
- 1 x 12 V AGM start battery 75 Ah.

Battery Chargers:

- Mastervolt battery charger 12V/50A.

Alternators:

- Alternator 12V/115A.

Other Electrical:

- Mastervolt EasyView 5 battery monitor.
- Mastervolt Isolation transformer mass GI 3.5.
- DC control panel.

**Plumbing Systems:***Fresh Water & Water Heating System:*

- 20L calorifier.

Bilge Pumps:

- 1 x Manual bilge pump.
- 1 x Electric bilge pump.

Tankage:*Fuel:*

- 1 x 100L Diesel tank.

Fresh Water:

- 1 x 200L.

Blackwater Holding Tanks:

- 1 x 50L.

Disclaimer

These particulars have been prepared from information provided by the vendors and are intended as a general guide to the yacht, their accuracy cannot be guaranteed by us. The purchaser should confirm details of concern to them by survey or engineer's inspection. The purchaser should also ensure that the purchase contract properly reflects their concerns and specifies details on which they may wish to rely.

Navigation Equipment:

- 1 x Compass with light.
- Axiom-Pro 9" chartplotter (2023).
- Quantum 2 Q24D radar.
- 3 x i70s instrument at companionway, Wind, Speed and Depth.
- 1 x p70s autopilot instrument at companionway.
- Autopilot with control unit.
- 1 x i70s instrument in nav.
- GPS antenna.
- 1 x logg transponder.
- 1 x depth transponder.
- 1 x wind transponder.
- 1 x VHF Ray63.
- 1 x Raymic second station.
- AIS700 transponder class-B.

Domestic Equipment:*Heating & Ventilation:*

- 1 x Diesel heater incl 4 outlets - Webasto Airtop EVO 40.
- 4 x Skylights.
- 10 x Portlights.
- 2 x Dorado vents.

Accommodation:*Summary of Accommodation:*

- Interior in mahogany, matt silk finish.
- Blinds for skylights and portlights.
- Beige cushions.
- Floorboards with holly strips, inspection hatches.
- 4-6 berths, owner's cabin, guest cabin and saloon.
- Heads with shower.
- L-sofa on port side, centerline foldable leaf table.
- Sofa port side.
- White inner ceiling, mahogany strips.
- Spotlights.
- Carpets.

Disclaimer

These particulars have been prepared from information provided by the vendors and are intended as a general guide to the yacht, their accuracy cannot be guaranteed by us. The purchaser should confirm details of concern to them by survey or engineer's inspection. The purchaser should also ensure that the purchase contract properly reflects their concerns and specifies details on which they may wish to rely.

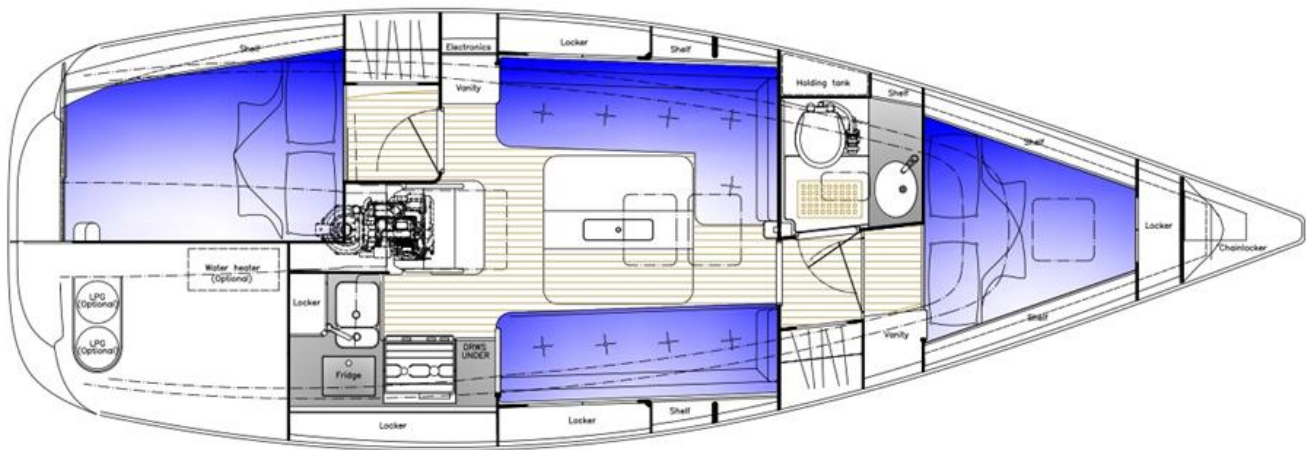
Internal Layout:*Description of layout from forwards:**Forward Cabin (Owner's):*

- Owner's cabin with double V-berth.
- 1 x hanging locker.
- 1 x cupboard with shelves.
- 1 x skylight with skyscreen (Ocean Air).
- Reading lights.
- Shelves for storage.

*Saloon:*

- Spacious saloon with ample of storage.
- Centerline foldable saloon table.
- Cupboards and bookshelves.
- Wine rack in saloon table.
- 2 x Skylights with skyscreen (Ocean Air).
- Grab handles.

Disclaimer

These particulars have been prepared from information provided by the vendors and are intended as a general guide to the yacht, their accuracy cannot be guaranteed by us. The purchaser should confirm details of concern to them by survey or engineer's inspection. The purchaser should also ensure that the purchase contract properly reflects their concerns and specifies details on which they may wish to rely.

- Portlights and fixed windows.
- Reading lights.
- Leecloths for port and starboard sofa.

**Disclaimer**

These particulars have been prepared from information provided by the vendors and are intended as a general guide to the yacht, their accuracy cannot be guaranteed by us. The purchaser should confirm details of concern to them by survey or engineer's inspection. The purchaser should also ensure that the purchase contract properly reflects their concerns and specifies details on which they may wish to rely.



Navigation Area:

- Navigation area port side.
- Cupboard for navigation equipment.



Galley:

- L-shape galley on starboard side.
- Locker and drawers for storage.
- Stove with 2 burners and oven.
- Double sink with water tap.
- Pressurized water.
- Fridge, watercooled (Isotherm).
- Foot pump for water.
- Binocular rack + Steinar binocular.



Disclaimer

These particulars have been prepared from information provided by the vendors and are intended as a general guide to the yacht, their accuracy cannot be guaranteed by us. The purchaser should confirm details of concern to them by survey or engineer's inspection. The purchaser should also ensure that the purchase contract properly reflects their concerns and specifies details on which they may wish to rely.

Head with Shower:

- Shower curtain.
- White laminate on bulkhead and lockers.
- Mirror on bulkhead, cupboard under sink.
- Composite material in countertop.
- Manual toilet.
- Skylight and portlight.

*Aft Cabin Port:*

- Aft cabin with double berth.
- Wardrobe and shelf.
- 2 x extra portlights.
- Reading lights.
- Storage under bed.

**Disclaimer**

These particulars have been prepared from information provided by the vendors and are intended as a general guide to the yacht, their accuracy cannot be guaranteed by us. The purchaser should confirm details of concern to them by survey or engineer's inspection. The purchaser should also ensure that the purchase contract properly reflects their concerns and specifies details on which they may wish to rely.

**Deck Equipment:***Rig:*

- Seldén Mast fractional conventional 2-spreader mast.
- Furlex TD furling system forestay, below deck.
- Boom with stack pack.
- Rodkick with gas spring.
- Backstay bridle with block system.
- Lazy Jack system.
- Gennaker equipment.
- Windex.
- Genoa tracks, adjustable from cockpit.
- Seldén spinnaker pole in carbon.
- Decklight.
- Aluminium rigging screw covers.
- Bowsprit for gennaker, stainless steel.

Winches:

- 2 x Lewmar genoa winch 40ST.
- 2 x Lewmar halyard winch 30ST.

Sails:

- Elvström main full batten, DC-Laminate.
- Elvström genoa with vertical battens, DC-Laminate.
- Elvström Gennaker with furling system.
- Seldén CX15 furler for gennaker.

General:

- LED navigation lights.
- Tricolour with anchor light in mast top.
- Storage for 3 gas bottles.
- Electric gas switch.
- Cockpit shower in cockpit, hot & cold water.

Disclaimer

These particulars have been prepared from information provided by the vendors and are intended as a general guide to the yacht, their accuracy cannot be guaranteed by us. The purchaser should confirm details of concern to them by survey or engineer's inspection. The purchaser should also ensure that the purchase contract properly reflects their concerns and specifies details on which they may wish to rely.

- Safety/ swim ladder, stainless steel.
- Pocket for winch handle.
- Grab handles on coach roof.
- Bathing platform.
- Flag pole.

Anchoring & Mooring Equipment:

- Lewmar electric windlass with galvanized Delta anchor 16kg and chain 40m.
- Bow fitting for anchor, stainless steel.
- Extra anchor, Fortress FX-16 4,5kg.
- Remote control for windlass.
- Chain counter in cockpit.
- 6 x Mooring cleats, stainless steel.
- 6 x Mooring lines.
- 6 x Fenders.

Tender & Outboard:

- Outboard bracket on pushpit.

Safety Equipment:

- EPIRB.
- Webbing jack stays.

Fire-Fighting Equipment:

- 2 x Fire extinguishers.

Disclaimer

These particulars have been prepared from information provided by the vendors and are intended as a general guide to the yacht, their accuracy cannot be guaranteed by us. The purchaser should confirm details of concern to them by survey or engineer's inspection. The purchaser should also ensure that the purchase contract properly reflects their concerns and specifies details on which they may wish to rely.

**Disclaimer**

These particulars have been prepared from information provided by the vendors and are intended as a general guide to the yacht, their accuracy cannot be guaranteed by us. The purchaser should confirm details of concern to them by survey or engineer's inspection. The purchaser should also ensure that the purchase contract properly reflects their concerns and specifies details on which they may wish to rely.

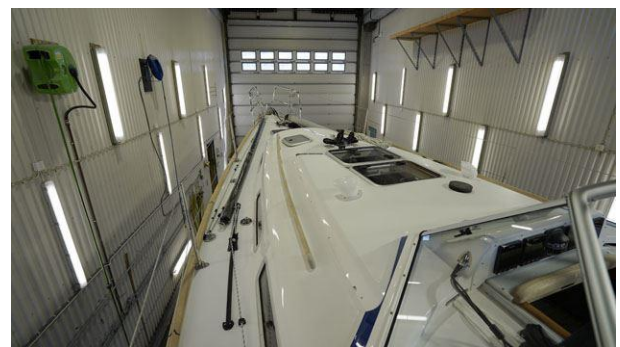
**Disclaimer**

These particulars have been prepared from information provided by the vendors and are intended as a general guide to the yacht, their accuracy cannot be guaranteed by us. The purchaser should confirm details of concern to them by survey or engineer's inspection. The purchaser should also ensure that the purchase contract properly reflects their concerns and specifies details on which they may wish to rely.

**Disclaimer**

These particulars have been prepared from information provided by the vendors and are intended as a general guide to the yacht, their accuracy cannot be guaranteed by us. The purchaser should confirm details of concern to them by survey or engineer's inspection. The purchaser should also ensure that the purchase contract properly reflects their concerns and specifies details on which they may wish to rely.

**Disclaimer**

These particulars have been prepared from information provided by the vendors and are intended as a general guide to the yacht, their accuracy cannot be guaranteed by us. The purchaser should confirm details of concern to them by survey or engineer's inspection. The purchaser should also ensure that the purchase contract properly reflects their concerns and specifies details on which they may wish to rely.

BERTHON
synonymous with yachting since 1877