



BLISS II

LOA:	47'5" / 14.45m
Year:	2018
LWL:	42'3" / 12.88m
Beam:	13'9" / 4.20m
Draft:	6'11" / 2.10m
Displacement:	13,300kg / 29,321lb
Hull Material:	GRP
Engines:	1 x Volvo Penta D2-75 75hp
Designer:	German Frers
Accommodation:	6 berths in 3 cabins
Builder:	Hallberg Rassy AB
Location:	Henån, Sweden
Price:	€735,000 VAT paid in EU

BERTHON

INTERNATIONAL YACHT BROKERS

Ängsvägen 16, 473 33 Henån

T: +46 304 694 000

E: brokers@berthonscandinavia.se

W: www.berthonscandinavia.com

Disclaimer

These particulars have been prepared from information provided by the vendors and are intended as a general guide to the yacht, their accuracy cannot be guaranteed by us. The purchaser should confirm details of concern to them by survey or engineer's inspection. The purchaser should also ensure that the purchase contract properly reflects their concerns and specifies details on which they may wish to rely.

Broker's Comments:

The Hallberg-Rassy 44 combines the best of what Hallberg-Rassy is known for, including contemporary improvements for fast and comfortable cruising. When launched in 2017, the HR44 became an instant commercial success with orders from all over the world. The Hallberg-Rassy 44 offers great sailing experience with superb comfort!

The modern hull shape with twin rudders, together with a large single steering wheel, makes controlling the yacht easy, especially in challenging weather conditions. The sail plan is contemporary and does not require runners, even when using an optional hard wind stay. The HR44 is also equipped with a bowsprit that can be used for a code sail or a gennaker and is also perfect for attaching a bow ladder to make boarding easy from floating docks and in natural harbours. The deck layout is neat and clutter-free, featuring an under-deck mounted electric windlass and flush-mounted deck hatches.

The large (2.29 m long) centre cockpit of the Hallberg-Rassy 44, equipped with a fixed wind screen and a sprayhood, offers exceptional protection. The spacious aft deck is great for sunbathing and socializing. The push button operated fold-out bathing platform is very useful for any water sport activities.

Inside you will find an owner's aft cabin with a centre double berth and an en suite head/shower, a forward cabin with V-berth and two bunk beds located to starboard in front of the mast bulkhead. There is also a forward head/shower compartment, a saloon with sofa, two armchairs and a solid table with folding sides. The navigation area is located to starboard of the entrance and the longitude galley is located to port. The woodwork is made of European Oak.

The Hallberg-Rassy 44 BLISS II has been lightly family sailed during summertime in Scandinavian waters. The general condition is really good for its age.

Key Facts:

- Electric in mast furling with dedicated electric out haul winch - 2022.
- Electric furling for genoa - 2022.
- Bow and stern thruster with docking function.
- Volvo D4-75.
- 3-blade Gori propeller.
- Motorized foldout bathing platform.
- Autopilot.
- 3 x MFD screens.
- AIS.
- Always stored inside during winter.
- Professionally maintained.
- Fully ready for the summer season.

Construction:

RCD Status: The yacht conforms with the essential safety requirements of Directive 94/25EC or RCDII (2013/53/EU as appropriate (Recreational Craft Directive) and is categorized A – "Ocean"

Hull, Deck & Superstructure Construction:

- Hull in sandwich construction with divynycell core.
- Single laminate in keel area.
- White gelcoat, vinylester based barrier coat.
- Two layers of epoxy primer.
- Antifouling - 2023.

Disclaimer

These particulars have been prepared from information provided by the vendors and are intended as a general guide to the yacht, their accuracy cannot be guaranteed by us. The purchaser should confirm details of concern to them by survey or engineer's inspection. The purchaser should also ensure that the purchase contract properly reflects their concerns and specifies details on which they may wish to rely.

- Integrated rubbing strake with brass strip.
- Blue decorative band in gelcoat.
- Engine foundations of GRP.
- Deck, coach roof and cockpit areas are made of sandwich construction, solid in certain areas, and laminated to the hull.
- Fold-out bathing platform, push button maneuvered.
- Teak (glued) on deck, cockpit and swim platform.
- Four hull portlights.

Keel & Rudder:

- Lead keel, bolted with stainless-steel bolts.
- Twin spade rudders.

Machinery:

Engine & Gearboxes:

- 1 x Volvo Penta D2-75, 55 kW/75 HP.
- Engine hours – approx. 767 hrs (MDI box was replaced 2017 at 340 hrs, instrument now showing 427).
- Additional light in engine room.
- Engine room fan.



Propulsion & Steering:

- Hydraulic gearbox.
- Centaflex flexible coupling.
- 3-blade folding propeller (Gori).
- 3-blade fixed propeller as spare.
- Single lever, electronic engine control.
- Bow and stern thruster, retractable, proportional drive (Sidepower).
- Cardan linked rod steering which is progressive and combines safety and fine feel in the best possible way.

Disclaimer

These particulars have been prepared from information provided by the vendors and are intended as a general guide to the yacht, their accuracy cannot be guaranteed by us. The purchaser should confirm details of concern to them by survey or engineer's inspection. The purchaser should also ensure that the purchase contract properly reflects their concerns and specifies details on which they may wish to rely.

Electrical Systems:*Battery Banks:*

- Engine battery 12V / 120 Ah.
- Service Batteries 12 V / 480 Ah (Flat Plate).

Battery Chargers:

- Alternator 12 V / 115 Ah.
- Charger/Inverter 230V / 150A / 12V / 3000W (Mastervolt).
- Battery monitor (Masterview).

Shore Power:

- 230 V Shore power system with earth breaker.
- Shore power cable.
- 4 x 230V outlets.

Other Electrical:

- Emergency switch for engine start.

Plumbing Systems:

- Deck wash pump with hose.

Fresh Water & Water Heating System:

- Hot water boiler 40 L.
- Fresh water pump.

Bilge Pumps:

- Bilge pump, manual.
- Bilge pump, electrical, auto/man, with float switch.

Tankage:*Fuel:*

- Diesel capacity approx. 420 L (92.38 gallons).

Fresh water:

- Fresh water capacity approx. 745 L (163.87 gallons).

Grey/Blackwater holding tanks:

- Holding tank capacity approx. 2 x 60 L, sea- and deck discharge.

Navigation Equipment:

- Illuminated compass.
- Autopilot (Raymarine p70).
- 4 x Sailing instruments (Raymarine i70s)
- Multifunction display (Raymarine Axiom-Pro 16) - behind the windscreen.
- Multifunction display (Raymarine Axiom-Pro 12+) - at the steering wheel.
- Multifunction display (Raymarine Axiom 7+) - at the chart table.
- Raymarine RMK-10 keypad - at the pedestal.

Disclaimer

These particulars have been prepared from information provided by the vendors and are intended as a general guide to the yacht, their accuracy cannot be guaranteed by us. The purchaser should confirm details of concern to them by survey or engineer's inspection. The purchaser should also ensure that the purchase contract properly reflects their concerns and specifies details on which they may wish to rely.

- AIS transponder (Raymarine AIS7000 class B).
- Fog horn.

Communications Equipment:

- VHF Ray63, DSC class D, two control units.
- VHF antenna with cable to navigation table.

Domestic Equipment:

- Washing machine, 230V/50Hz.

Galley:

- Double sink.
- Waste bin.
- Dishwasher Electrolux, 230V.
- Fan extractor over stove.
- Fridge box.
- Freezer / Fridge box.

Heads/Shower:

- 2 x Electric WCs.
- 2 x Showers.
- 2 x Shower drain pumps.
- Shower pump for bathing platform.

Heating & Ventilation:

- Diesel heater (Webasto Airtop EVO 55) with insulated hoses and outlets in each cabin and heads.
- 8 x Portlights, opening type.
- 6 x Skylights, opening type, flush mounted.
- 7 x Automatic vents for saloon, aft cabin, forward heads and forward cabin.

Entertainment:

- Marine TV/FM antenna (UFO).
- Stereo (Fusion RA770) - connected to MFD.
- 2 x Loudspeakers in the saloon.
- 2 x Loudspeakers in the cockpit.
- TV 40", retractable.

Lighting:

- Indirect lighting package.

Accommodation:*Summary of Accommodation:*

- Sleep 6 persons in 3 cabins.
- Interior woodwork in varnished European Oak.
- Blue colored upholstery.
- Blue colored carpet all through the boat.
- Blinds at all portlights and hull windows.
- Curtains at all skylights.

Disclaimer

These particulars have been prepared from information provided by the vendors and are intended as a general guide to the yacht, their accuracy cannot be guaranteed by us. The purchaser should confirm details of concern to them by survey or engineer's inspection. The purchaser should also ensure that the purchase contract properly reflects their concerns and specifies details on which they may wish to rely.

- Ship clock (Wempe).
- Barometer (Wempe).
- Hygrometer / thermometer (Wempe).

Internal Layout:

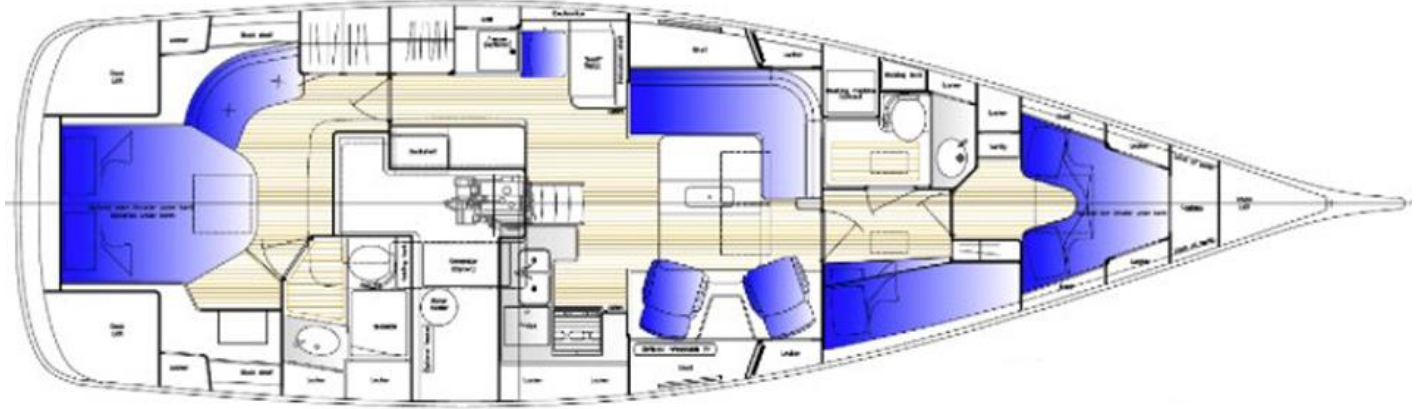

Description of layout from forwards:

Forward Cabin:

- V-berths with ample stowage below.
- Infill for v-berth.
- Lockers and shelves above the berth.
- Wardrobe to port.
- Skylight / emergency exit.



Disclaimer

These particulars have been prepared from information provided by the vendors and are intended as a general guide to the yacht, their accuracy cannot be guaranteed by us. The purchaser should confirm details of concern to them by survey or engineer's inspection. The purchaser should also ensure that the purchase contract properly reflects their concerns and specifies details on which they may wish to rely.



Forward Guest Cabin (Stbd):

- Bunk bed.
- Wardrobe.
- Locker.
- Shelf.
- Opening portlight.
- Lee cloth in lower berth.



Disclaimer

These particulars have been prepared from information provided by the vendors and are intended as a general guide to the yacht, their accuracy cannot be guaranteed by us. The purchaser should confirm details of concern to them by survey or engineer's inspection. The purchaser should also ensure that the purchase contract properly reflects their concerns and specifies details on which they may wish to rely.



Forward Heads:

- Bulkheads in white laminate.
- Teak floorboard.
- Wash basin and countertop in Corian type material.
- Water tap mixer.
- Mirror.
- Cupboards above and below wash basin.
- Separate shower with plexi glass doors.
- Electric toilet.
- Opening portlight and skylight.



Saloon:

- Saloon with sofa to port.
- Saloon table with 2 x folding parts and bottle storage.
- 2 x Armchair to starboard.
- Table / cupboard for glasses between the chairs.

Disclaimer

These particulars have been prepared from information provided by the vendors and are intended as a general guide to the yacht, their accuracy cannot be guaranteed by us. The purchaser should confirm details of concern to them by survey or engineer's inspection. The purchaser should also ensure that the purchase contract properly reflects their concerns and specifies details on which they may wish to rely.

**Disclaimer**

These particulars have been prepared from information provided by the vendors and are intended as a general guide to the yacht, their accuracy cannot be guaranteed by us. The purchaser should confirm details of concern to them by survey or engineer's inspection. The purchaser should also ensure that the purchase contract properly reflects their concerns and specifies details on which they may wish to rely.



Navigation Area:

- Chart table.
- Space for instruments.
- Navigation chair.
- Shelves behind the navigation seat.
- 4 x drawers.



Galley:

- Linear galley to port.
- Working surface in Corian type material, with a solid, all round mahogany fiddle rail.
- Manual gas shut off valve.
- Crockery lockers and cutlery drawers.
- Cutting board.
- Room for saucepans and other kitchen equipment.

Disclaimer

These particulars have been prepared from information provided by the vendors and are intended as a general guide to the yacht, their accuracy cannot be guaranteed by us. The purchaser should confirm details of concern to them by survey or engineer's inspection. The purchaser should also ensure that the purchase contract properly reflects their concerns and specifies details on which they may wish to rely.



Aft Cabin:

- Centre berth.
- Spring mattresses.
- Topping mattress.
- Hanging locker to port.
- Seat to port.
- Worktable to starboard, with stowage room below and above.
- Mirror.

Disclaimer

These particulars have been prepared from information provided by the vendors and are intended as a general guide to the yacht, their accuracy cannot be guaranteed by us. The purchaser should confirm details of concern to them by survey or engineer's inspection. The purchaser should also ensure that the purchase contract properly reflects their concerns and specifies details on which they may wish to rely.



Aft Heads:

- Bulkheads in white laminate.
- Teak floor board.
- Wash basin and countertop in Corian type material.
- Water tap mixer.
- Mirror.
- Cupboards above and below wash basin.
- Separate shower with plexi glass doors.
- Electric toilet.

Disclaimer

These particulars have been prepared from information provided by the vendors and are intended as a general guide to the yacht, their accuracy cannot be guaranteed by us. The purchaser should confirm details of concern to them by survey or engineer's inspection. The purchaser should also ensure that the purchase contract properly reflects their concerns and specifies details on which they may wish to rely.



Cockpit:

- High gloss varnished entrance and chart table.
- High gloss varnished sliding washboard.
- Leather covered stainless steel twin sprockets steering wheel.
- Windscreen in tempered glass with opening mid-section.
- 2 x Grab rails outside of windscreen.
- Grab rail integrated in the sprayhood frame.

Deck Equipment:

Rig:

- Electric furling mast (Seldén) with dedicated electric outhaul winch (Lewmar 40EST) - 2022
- Electric furler for genoa, under deck mounted (Seldén Furlex TDE).
- Hydraulic back stay tensioner - 2022.
- Boom vang (Seldén).
- Code-0 halyard.
- LED Tri-color and anchor light.
- Windex.
- Bowsprit for code zero or gennaker.
- Spinnaker boom, carbon.
- Deck gear (Seldén).
- Genoa and mainsheet tracks adjustable from the cockpit.
- Line clutches (Spinlock).

Winches:

- Electric mainsheet winch (Lewmar 40EST).
- 2 x Electric genoa winches (Lewmar 55EST).
- Electric out haul winch (Lewmar 40EST).

Sails:

- Furling main sail (Elvström FatFurl, EPEX) - 2022.
- Furling Jib 107% with vertical battens (Elvström EPEX, UV protection) - 2022.

Disclaimer

These particulars have been prepared from information provided by the vendors and are intended as a general guide to the yacht, their accuracy cannot be guaranteed by us. The purchaser should confirm details of concern to them by survey or engineer's inspection. The purchaser should also ensure that the purchase contract properly reflects their concerns and specifies details on which they may wish to rely.

- E-Flex reefing flattener for genoa jib - 2022.

General:

- Motorized foldout bathing platform.
- G&T seats in pushpit.
- Opening gates in lifelines port and starboard.
- Bow ladder.
- LED navigation lights.
- Gas locker with stowage for two 6 kg bottles.
- Gas bottle, 6 kg.
- Anchor locker.
- 2 x Storage locker in the stern.
- Teak hand rails full length of superstructure.
- Flagpole.

Anchoring & Mooring Equipment:

- Electric windlass.
- Anchor, 27 kg, stainless steel (Ultra).
- Anchor chain, galvanized, 70 m x 8 mm.
- Remote control for windlass on pedestal.
- Anchor chain meter counter on pedestal.
- 4 x Mooring lines.
- 6 x Fenders.
- 4 x Cleats.
- 2 x Spring cleats.
- 2 x Fair leads on the stern.
- Brass strips at all cleats.

Covers, Canvas & Cushions:

- Sprayhood - 2022.
- Sprayhood extension / cockpit tent.
- Canvas cover for cockpit table and steering wheel.

Fire-fighting equipment:

- 3 x Fire extinguishers.
- Automatic fire extinguisher in the engine room.

Disclaimer

These particulars have been prepared from information provided by the vendors and are intended as a general guide to the yacht, their accuracy cannot be guaranteed by us. The purchaser should confirm details of concern to them by survey or engineer's inspection. The purchaser should also ensure that the purchase contract properly reflects their concerns and specifies details on which they may wish to rely.

**Disclaimer**

These particulars have been prepared from information provided by the vendors and are intended as a general guide to the yacht, their accuracy cannot be guaranteed by us. The purchaser should confirm details of concern to them by survey or engineer's inspection. The purchaser should also ensure that the purchase contract properly reflects their concerns and specifies details on which they may wish to rely.

**Disclaimer**

These particulars have been prepared from information provided by the vendors and are intended as a general guide to the yacht, their accuracy cannot be guaranteed by us. The purchaser should confirm details of concern to them by survey or engineer's inspection. The purchaser should also ensure that the purchase contract properly reflects their concerns and specifies details on which they may wish to rely.

**Disclaimer**

These particulars have been prepared from information provided by the vendors and are intended as a general guide to the yacht, their accuracy cannot be guaranteed by us. The purchaser should confirm details of concern to them by survey or engineer's inspection. The purchaser should also ensure that the purchase contract properly reflects their concerns and specifies details on which they may wish to rely.

**Disclaimer**

These particulars have been prepared from information provided by the vendors and are intended as a general guide to the yacht, their accuracy cannot be guaranteed by us. The purchaser should confirm details of concern to them by survey or engineer's inspection. The purchaser should also ensure that the purchase contract properly reflects their concerns and specifies details on which they may wish to rely.

**Disclaimer**

These particulars have been prepared from information provided by the vendors and are intended as a general guide to the yacht, their accuracy cannot be guaranteed by us. The purchaser should confirm details of concern to them by survey or engineer's inspection. The purchaser should also ensure that the purchase contract properly reflects their concerns and specifies details on which they may wish to rely.

BERTHON
synonymous with yachting since 1877