



## GALATEA

LOA:	48'8" / 14.83m
Year:	2000
HIN No.:	FI-SWN48137E000
Beam:	14'2" / 4.32m
Draft:	7'9" / 2.37m
Displacement:	15,000kg / 33,069lb
Hull Material:	GRP
Engines:	1 x Volvo D2 75
Designer:	German Frers
Accommodation:	6 berths in 3 cabins.
Builder:	Nautor's Swan
Location:	Vindö, Sweden
Price:	NOK3,795,000 VAT paid in Norway

# BERTHON

INTERNATIONAL YACHT BROKERS

Ängsvägen 16, 473 33 Henån

T: +46 304 694 000

E: [brokers@berthonscandinavia.se](mailto:brokers@berthonscandinavia.se)

W: [www.berthonscandinavia.com](http://www.berthonscandinavia.com)

### Disclaimer

*These particulars have been prepared from information provided by the vendors and are intended as a general guide to the yacht, their accuracy cannot be guaranteed by us. The purchaser should confirm details of concern to them by survey or engineer's inspection. The purchaser should also ensure that the purchase contract properly reflects their concerns and specifies details on which they may wish to rely.*

**Broker's Comments:**

The Nautor Swan 48 was designed by German Frers and built between 1995-2002. A total of 57 units were delivered from the renowned Finnish yacht builder. Nautor Swan 48s are cruiser racers that offers exciting sailing performance and great accommodation for six people in three cabins.

Nautor Swan 48, GALATEA has been continuously maintained and upgraded by caring owners to meet modern comfort and performance requirements. She has a beautiful dark blue hull (awl gripped), that is very well taken care of teak deck and an interior in superb condition.

Her layout consists of an owner's aft cabin, with separate entrance and en-suite heads/shower, a saloon with proper navigation table and the galley - extending aft towards the owner's cabin. This offers plenty of space, a fridge, a combined fridge/freezer box and a gas stove. Forward of this is the mast bulkhead and two further bunk bed cabins and a head / shower cabin.

By now, GALATEA has sailed approx. 25,000nm, never crossed the Atlantic and has been cared for and maintained as she deserves. If you are looking for a well-maintained Swan 48, here it is...

**Key Facts:**

- Sleep 6 berths in 3 cabins.
- Cruiser/racer version.
- Main sail (North 3Di) – 2021.
- Genoa (North 3Di) – 2021.
- Dark blue hull (AwlGrip).
- Epoxy treatment – 2017.
- Carbon bow sprit – 2015.
- Sprayhood – 2015.
- Volvo Penta D2 75 – 2016.

**Construction:**

*RCD Status: The yacht conforms with the essential safety requirements of Directive 94/25EC or RCDII (2013/53/EU as appropriate (Recreational Craft Directive) and is categorised A – "Ocean"*

**Hull, Deck & Superstructure Construction:**

- GRP construction.
- Dark blue hull with white trim lines
- All antifouling removed, 5 layers epoxy and 2 layers of antifouling applied - 2017.
- Antifouling - 2022.
- Teak on side decks, coach roof, cockpit, toe rail and swim platform.
- All teak lightly sanded, some caulking re-done - 2016.

**Keel & Rudder:**

- Fin keel.
- Spade rudder.

**Machinery:****Engine & Gearboxes:**

- Volvo D2 75, approx. 750 hrs - 2016.
- Hydraulic gear box - 2016.

**Disclaimer**

*These particulars have been prepared from information provided by the vendors and are intended as a general guide to the yacht, their accuracy cannot be guaranteed by us. The purchaser should confirm details of concern to them by survey or engineer's inspection. The purchaser should also ensure that the purchase contract properly reflects their concerns and specifies details on which they may wish to rely.*

- 3-blade folding propeller (Max-prop).
- Engine room refurbished (gelcoat/insulation) - 2016.
- Double diesel pre-filters with water separator - 2019.



#### *Engine Performance:*

- Maximum speed: approx. 9.0 knots.
- Comfortable and fuel-efficient cruising speed: approx. 7.5 knots.

#### **Electrical Systems:**

##### *Battery Banks:*

- Service batteries, lead, 24 V / 320 Ah (12 x 2 V cells) - 2011.
- Engine battery, gel, 12 V / 90 Ah - 2011.

##### *Battery Chargers:*

- Battery charger / inverter (Victron Multiplus compact) 24 / 2000 / 50-30 - 2018.
- Battery monitor including shunt (Victron BMV 712) - 2018.

##### *Shore Power:*

- Shore power system.

##### *Other Electrical:*

- 12 V outlet at nav station.
- 12 x 220V outlets.
- Digital multi control panel (Victron) - 2018.
- Inverter (Atlas) 24 / 300 VA for TV.

#### **Plumbing Systems:**

##### *Bilge Pumps:*

- Electric bilge pump (Johnson) - 2017.
- Two manual bilge pumps, one operated from cockpit, one from sole board at nav station.

#### **Tankage:**

##### *Fuel:*

- Total fuel capacity of 300L.

##### *Fresh water:*

- Total water capacity of 300L.
- Hot water boiler capacity approx. 25 L.

#### **Disclaimer**

*These particulars have been prepared from information provided by the vendors and are intended as a general guide to the yacht, their accuracy cannot be guaranteed by us. The purchaser should confirm details of concern to them by survey or engineer's inspection. The purchaser should also ensure that the purchase contract properly reflects their concerns and specifies details on which they may wish to rely.*



- Pressurized fresh water system.
- Previously installed watermaker removed.

#### *Grey/Blackwater holding tanks:*

- Grey water holding tank, manual discharge pump - 2016 and electrical drainage pump.

#### **Navigation Equipment:**

- Compass.
- Wind instrument (Raymarine) at entrance.
- 4 x Multi-function displays (Raymarine) at nav, entrance, steering pedestal and aft cabin.
- Plotter (Raymarine A9) at nav station.
- Plotter (Raymarine C9) at steering pedestal.
- SeaTalk/SeaTalk NG converter - 2015.
- Radar (Raymarine HD colour) - 2015.
- Differential GPS (Raystar 114) on pushpit.
- Differential GPS for AIS on pushpit.
- AIS transponder (True Heading Carbon CTRX) - 2012.
- AIS Shipmate at nav station - 2012.
- Autopilot (Raymarine Evolution 400) with course computer and P 70 instrument - 2016.
- Remote control (Smart) on crash bar - 2017.
- Autopilot, radar, plotters and AIS software updated and calibrated - 2019.
- VHF Ray 260 DSC, handset at nav station and in cockpit.
- Wi-Fi system, 4G router, connected to antenna (Delta) in mast.
- Active antenna (Delta Pacific 3G/VHF/TV).

#### **Domestic Equipment:**

##### *Heating & Ventilation:*

- Water heating system by engine and shore power.
- Diesel heater (Eberspächer D5W) - 2012 water based system, 3 fan units, outlets in all cabins and toilets.
- Electrical fans fwd /aft toilet and galley.

##### *Entertainment:*

- TV (LG LED 20").
- Stereo (Fusion).
- Apple TV - 2014.
- Speakers (Poly Planar) in saloon, owner's cabin and cockpit.
- Stainless steel protection for two cockpit speakers.

##### *Lighting:*

- Additional bulkhead lights in saloon (Cabin 21 chrome).
- Indirect light in saloon, above bookshelf both side.

#### **Accommodation:**

##### *Summary of Accommodation:*

- 6 berths in 3 cabins.
- Saloon settees, chairs, navigation seat soft cream leather - 2015.
- Carpet in all cabins - 2011.

#### **Disclaimer**

*These particulars have been prepared from information provided by the vendors and are intended as a general guide to the yacht, their accuracy cannot be guaranteed by us. The purchaser should confirm details of concern to them by survey or engineer's inspection. The purchaser should also ensure that the purchase contract properly reflects their concerns and specifies details on which they may wish to rely.*

- Mattresses Sirius, yellow.
- Day cover for all beds, Sirius, blue.
- Flush push button lockers matt polished.
- Curtains, off white - 2015.
- Leather upholstery, off white, for saloon - 2015.
- Interior woodwork well maintained.
- All openable skylights and portlights of top quality (original), no leaks.

*Internal Layout:*

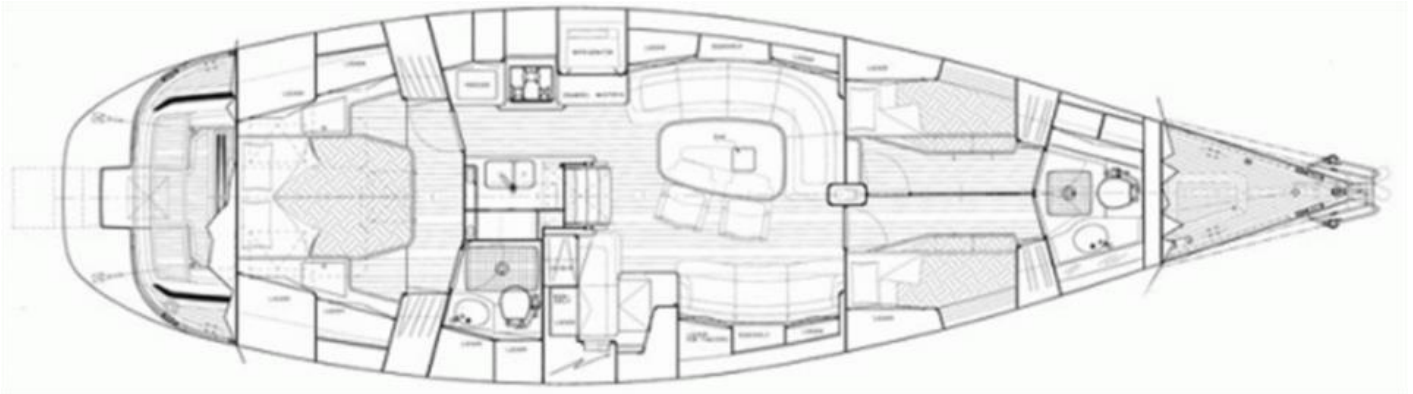

*Description of layout from forwards:*

*Forward Toilet:*

- Forward electric toilet (Jabsco) with dedicated stainless steel holding tank. Manual discharge pump - 2015 and deck evacuation.
- Toilet hoses - 2016.
- "Telephone" type shower.
- 3 x Storage cabinets port as well as one storage cabinet below sink.
- Shower drains directly to sea.



**Disclaimer**

*These particulars have been prepared from information provided by the vendors and are intended as a general guide to the yacht, their accuracy cannot be guaranteed by us. The purchaser should confirm details of concern to them by survey or engineer's inspection. The purchaser should also ensure that the purchase contract properly reflects their concerns and specifies details on which they may wish to rely.*

*Port Forward Cabin:*

- Bunk beds.
- 2 x Storage cabinets hull side of top bunk bed.
- 2 x Drawers underneath lower bunk bed.
- Hanging locker forward.

*Starboard Forward Cabin:*

- Bunk beds.
- 2 x Storage cabinets hull side of top bunk bed.
- 2 x Drawers underneath lower bunk bed.
- Hanging locker forward.

*Saloon:*

- Swan chairs in saloon, starboard of saloon table.
- Bottle storage and 220 V panel under saloon table.
- Port sofa holds the 2 x refrigeration systems, charger/inverter as well as batteries up against port fore cabin.

**Disclaimer**

*These particulars have been prepared from information provided by the vendors and are intended as a general guide to the yacht, their accuracy cannot be guaranteed by us. The purchaser should confirm details of concern to them by survey or engineer's inspection. The purchaser should also ensure that the purchase contract properly reflects their concerns and specifies details on which they may wish to rely.*



- 3 x Small storage rooms hull side behind back rests.
- Starboard sofa has 3 x storage rooms under cushions and 3 x small storage rooms hull side behind back rests.



#### Galley:

- 3 burner Force 10 with oven - 2018.
- Front loaded fridge.
- Top loaded freezer (can also be operated as an extra fridge).
- Nespresso machine - 2019.
- Refrigerator (Iceberg, 230 V, 0.5 hp, 50/60 Hz).
- Engine driven compressor (Iceberg).
- Ample storage room for cutlery, cups, glasses, double sink, dish wash tray draining to sink.
- Full set of crystal glasses engraved with "G", Höganäs cutlery, crystal bowls.

#### Disclaimer

*These particulars have been prepared from information provided by the vendors and are intended as a general guide to the yacht, their accuracy cannot be guaranteed by us. The purchaser should confirm details of concern to them by survey or engineer's inspection. The purchaser should also ensure that the purchase contract properly reflects their concerns and specifies details on which they may wish to rely.*



#### Navigation Area:

- Laptop can be installed on an extractable shelf below plotter.
- Large storage room under nav seat, in locker under bookshelf as well as in oilskin locker GRP bottom in oilskin locker, drains to keel.



#### Disclaimer

*These particulars have been prepared from information provided by the vendors and are intended as a general guide to the yacht, their accuracy cannot be guaranteed by us. The purchaser should confirm details of concern to them by survey or engineer's inspection. The purchaser should also ensure that the purchase contract properly reflects their concerns and specifies details on which they may wish to rely.*





**Aft Cabin:**

- Centerline double bed.
- Ample storage in hull side lockers (6), hanging lockers (2), drawers foot end bed (2), large storage rooms beside (2) as well as storage rooms under mattress.



**Disclaimer**

*These particulars have been prepared from information provided by the vendors and are intended as a general guide to the yacht, their accuracy cannot be guaranteed by us. The purchaser should confirm details of concern to them by survey or engineer's inspection. The purchaser should also ensure that the purchase contract properly reflects their concerns and specifies details on which they may wish to rely.*



#### Toilet Aft:

- Aft manual toilet (Jabsco) - 2015 with dedicated stainless steel holding tank, manual discharge pump (- 2016) and deck evacuation.
- Teak grating on floor instead of standard tiles.
- Manual toilet, renewed hoses to sea/holding tank.
- Shower is "telephone" type, drains to grey water tank.
- 2 x Large cabinets above sink, 1 x large cabinet underneath sink.



#### Cockpit:

- Modified compass crash bar, tunable bracket for plotter, mug holders.
- 2 x Large storage rooms under cockpit bench (SB and PT).
- 2 x Storage rooms aft cockpit (each side of fold down swim ladder, one stores gas bottle).
- Large lazarette (we store G4, G3 and the large gennaker here plus beach kit).
- Cockpit table.
- Removable stool with backrest for aft entrance.

#### Deck Equipment:

##### Rig:

- Mast, aluminum (Nautor Swan).
- Boom, aluminum, (Nautor Swan).
- Spinnaker pole, aluminum, refurbished - 2017.

##### Disclaimer

*These particulars have been prepared from information provided by the vendors and are intended as a general guide to the yacht, their accuracy cannot be guaranteed by us. The purchaser should confirm details of concern to them by survey or engineer's inspection. The purchaser should also ensure that the purchase contract properly reflects their concerns and specifies details on which they may wish to rely.*

- Jockey pole, aluminum, refurbished - 2017.
- Main mast track system (Harken System B).
- Furler for head sail (Harken unit 3), fully serviced - 2018.
- All halyards (Dyneema) - 2015 / 2017.
- Sheet / guys for spinnaker - 2015.
- Runners & check stays (no-stretch Dyneema) - 2016.
- Spreader deck light.
- LED top light.
- 2 x Mast steps, folding type.
- Windex - 2016.
- Aluminum bow sprit with Harken block.
- Carbon bow sprit (Offshore Spars) - 2015 with dead end and Harken block, providing 2:1 purchase on tack line for Code 0 and asymmetrical spinnaker, fairleads on the teak toe rail.
- Blocks and clutch for furling line on deck Harken H3012, H1963.
- White painted pole for radar antenna.

#### Winches:

- 2 x Lewmar 64 CEST primary winches, mounted aft. recessed in coamings.
- 2 x Lewmar 64 CST secondary winches, mounted aft. recessed in coamings.
- Lewmar 48 CST main sheet winch, recessed aft on port side.
- Lewmar 44 CST main sheet winch, SB.
- Lewmar 16 CST traveler control winch, PT.
- 2 x Lewmar 48 CST halyard winches.
- Hydraulic panel (Navtec System 50), 2-speed pump for backstay, kick and baby stay, professionally serviced - 2023.

#### Sails:

- Mainsail (North 3Di) - 2021.
- Genoa (North 3Di) - 2021.
- Code 0 (Quantum) including furler - 2015.
- Gennaker (Doyle) with snuffer, reaching, approx. 170m<sup>2</sup>.
- Spinnaker (North) 1,5 oz, red, with snuffer.
- Try sail or storm jib (unknown) - 2000.
- Main sail (Quantum), carbon/twaron, tafetta one side - 2015.
- Furling G3 (Evolution), carbon/tawron, tafetta one side - 2016.
- G2 (Rustad Sails) 135%, carbon/tawron, tafetta one side - 2019.
- Genoa 1 (North 3 DL) 150%, light, aramid, film/film.
- Genoa 1 (North 3 DL) 140% medium/heavy, aramid, film/taffeta.
- Furling genoa 2 (North 3 DL) 130%, aramid, double taffeta. (Well used).
- Gennaker (North) 0,75 oz, pink, (formerly spinnaker – converted to run gennaker).
- Cutter sail (Dacron) Dynema hanks for inner forestay - 2000.

#### General:

- Flagpole.
- Deck wash system (fresh cold & warm + seawater).
- Deck shower (hot and cold water in aft cockpit)

#### Anchoring & Mooring Equipment:

- Electric windlass, Rocna Vulcan 25 kg - 2016, approx 70 m x 10 mm chain.
- Double removable anchor rollers.

#### Disclaimer

*These particulars have been prepared from information provided by the vendors and are intended as a general guide to the yacht, their accuracy cannot be guaranteed by us. The purchaser should confirm details of concern to them by survey or engineer's inspection. The purchaser should also ensure that the purchase contract properly reflects their concerns and specifies details on which they may wish to rely.*



- Stainless steel bar in the anchor box for storing of sheets.
- Spare anchor: Bruce 20 kg, 5 m x 10 mm chain.
- Spare anchor: Original CQR anchor.
- 6 x Cleats.
- 4 x Mooring lines.
- 4 x Fenders.

*Covers, Canvas & Cushions:*

- Mainsail cover - 2017.
- Spray dodgers for both cockpits - 2015.
- Cover for pedestal - 2015.
- Custom made cockpit cushions - 2015.

*Tender & Outboard:*

- Dinghy and outboard 6hp (Honda) - 2020.
- Bracket on pushpit for outboard engine.

*Safety Equipment:*

- Life raft.

*Fire-fighting equipment:*

- Fire extinguisher in engine room with remote control.

**Disclaimer**

*These particulars have been prepared from information provided by the vendors and are intended as a general guide to the yacht, their accuracy cannot be guaranteed by us. The purchaser should confirm details of concern to them by survey or engineer's inspection. The purchaser should also ensure that the purchase contract properly reflects their concerns and specifies details on which they may wish to rely.*

**Disclaimer**

*These particulars have been prepared from information provided by the vendors and are intended as a general guide to the yacht, their accuracy cannot be guaranteed by us. The purchaser should confirm details of concern to them by survey or engineer's inspection. The purchaser should also ensure that the purchase contract properly reflects their concerns and specifies details on which they may wish to rely.*

**Disclaimer**

*These particulars have been prepared from information provided by the vendors and are intended as a general guide to the yacht, their accuracy cannot be guaranteed by us. The purchaser should confirm details of concern to them by survey or engineer's inspection. The purchaser should also ensure that the purchase contract properly reflects their concerns and specifies details on which they may wish to rely.*



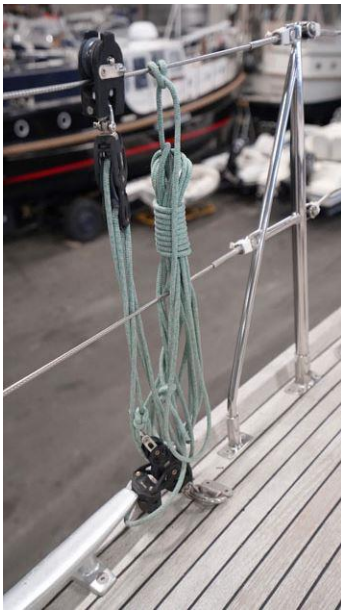
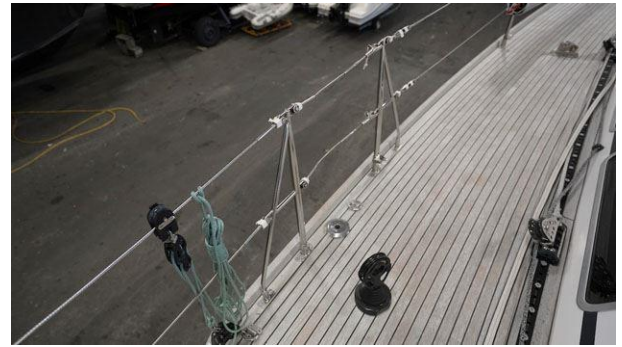

**Disclaimer**

*These particulars have been prepared from information provided by the vendors and are intended as a general guide to the yacht, their accuracy cannot be guaranteed by us. The purchaser should confirm details of concern to them by survey or engineer's inspection. The purchaser should also ensure that the purchase contract properly reflects their concerns and specifies details on which they may wish to rely.*



**Disclaimer**

*These particulars have been prepared from information provided by the vendors and are intended as a general guide to the yacht, their accuracy cannot be guaranteed by us. The purchaser should confirm details of concern to them by survey or engineer's inspection. The purchaser should also ensure that the purchase contract properly reflects their concerns and specifies details on which they may wish to rely.*

**Disclaimer**

*These particulars have been prepared from information provided by the vendors and are intended as a general guide to the yacht, their accuracy cannot be guaranteed by us. The purchaser should confirm details of concern to them by survey or engineer's inspection. The purchaser should also ensure that the purchase contract properly reflects their concerns and specifies details on which they may wish to rely.*



**Disclaimer**

*These particulars have been prepared from information provided by the vendors and are intended as a general guide to the yacht, their accuracy cannot be guaranteed by us. The purchaser should confirm details of concern to them by survey or engineer's inspection. The purchaser should also ensure that the purchase contract properly reflects their concerns and specifies details on which they may wish to rely.*

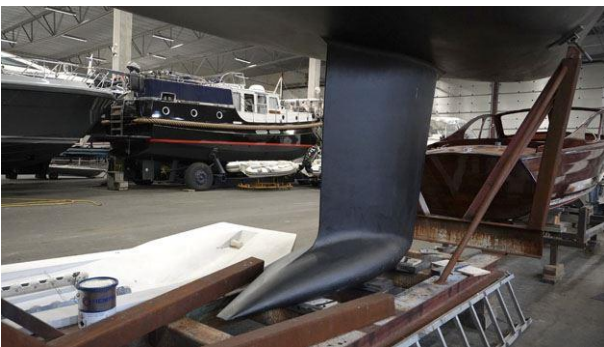
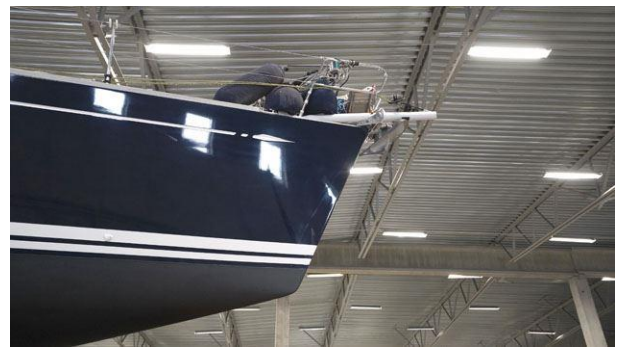

**Disclaimer**

*These particulars have been prepared from information provided by the vendors and are intended as a general guide to the yacht, their accuracy cannot be guaranteed by us. The purchaser should confirm details of concern to them by survey or engineer's inspection. The purchaser should also ensure that the purchase contract properly reflects their concerns and specifies details on which they may wish to rely.*

**Disclaimer**

*These particulars have been prepared from information provided by the vendors and are intended as a general guide to the yacht, their accuracy cannot be guaranteed by us. The purchaser should confirm details of concern to them by survey or engineer's inspection. The purchaser should also ensure that the purchase contract properly reflects their concerns and specifies details on which they may wish to rely.*