



Hallberg-Rassy 43 > FREDRIKA



Price	€325,000 EU VAT paid
Location	Henån, Sweden
Year	2003
LOA	44'6" / 13.57m
LWL	38'7" / 11.75m
Beam	13'5" / 4.08m
Draft	6'7" / 2m
Displacement	12,904kg / 28,448lb
Hull Material	GRP
Engine	1 x Volvo D2-75
Builder	Hallberg-Rassy
Designer	German Frers
Accommodation	7 berths in 2 cabins and saloon



BROKER'S COMMENTS

The Hallberg-Rassy 43 is a well-built and well-proven bluewater cruiser. 199 units were delivered from the yard between 2001 - 2016. It is an excellent yacht for both coastal and ocean sailing. The HR43 offers a very comfortable and spacious two-cabin layout with a large owner's aft cabin, a sea going galley, an ergonomic navigation area, forward guest cabin and two heads with shower. Other typical Hallberg-Rassy features includes the large and service friendly engine room, a center cockpit with a protective windshield, generous tankage, a rubbing strake on the hull and timeless beautiful lines. Shortly described - a superb yacht for cruising and long term liveaboard.

The first owner took this Hallberg-Rassy 43, FREDRIKA on a trip to the Caribbean and back in 2004, after that it has sailed in Scandinavian, mainly in Swedish waters until 2016 when the second owners bought the yacht. It got a big refit at Adams Boat Care to be prepared for another Caribbean trip. FREDRIKA did the ARC in 2019 and was shipped back to Europe in 2020. The third (current) owner bought the yacht in 2021. In recent years the yacht has had new upholstery, running rigging, canvas, davits, batteries, through hull fittings, sailing instruments, a big engine service and much more.

This is a well-equipped and nicely updated yacht that is available at our showing dock in Henån - ready for new adventures!

Explore more photos here: <https://www.berthoninternational.com/yacht-sales-brokerage/yachts-for-sale/hallberg-rassy-43-fredrika/>

Key Facts:

- Electric in-mast furling.
- Standing rigging - 2019.
- 3 x Electric winches.
- Main sail & Genoa - 2012.
- Davits - 2022.
- Canvas - 2021 / 2022.
- Volvo D2-75 - extended service 2019 / 2022.
- Generator (Whisper 3,5) - extended service 2019.
- Batteries (AGM) - 2022.
- 220 V Charger - 2020.
- Updated Navigation system.
- Satellite phone (Sailor SC4000).
- Washing machine.
- Watermaker (Spectra).

CONSTRUCTION

RCD Status: The yacht conforms with the essential safety requirements of Directive 94/25EC or RCDII (2013/53/EU as appropriate (Recreational Craft Directive) and is categorised A – "Ocean" (or Cat B – whichever is appropriate)

Hull, Deck & Superstructure Construction:

- White hull with blue trim lines.
- Blue trim lines on hull sides - 2022.
- HR43 model logotype - 2022.
- Integrated rubbing strake.
- Deep bilge.

- White deck and coach roof.
- Antifouling - 2023.
- Polish of hull and deck - 2023.
- Solid teak on deck, coach roof, cockpit and swim platform - serviced and lightly sanded 2021.
- Antifouling (Copper Coat) - 2019.
- Through hulls in bronze - 2017.
- 3 x Through hulls replaced - 2022.

Keel & Rudder:

- The keel is bolted to the bilge.
- Skeg hung rudder.
- Skeg rudder shaft bearing replaced - 2015.

MACHINERY

Engine & Gearboxes:

- Volvo D2-75, approx. 3600 hrs (autumn 2023).
- Fuel filter double (Racor).
- Diesel tank cleaning pump with connection to the deepest point of the fuel tank - 2017.

Maintenance & Performance:

- Extended engine service – 2016/2022.
- Turbo - 2022.
- Muffler - 2022.
- Engine mounts - 2018.
- Shaft seal - 2022.
- Cutlass bearing - 2015.

Propulsion & Steering:

- Bow thruster (Sidepower), updated to 5 blade propeller - 2022.
- Propeller 22x16x3 R (Flexofold) - 2020.
- Line cutter.
- Spare fixed propeller (22x16x3).
- Rod steering system (Whitlock), universal joints replaced 2016.
- Emergency steering gear.
- Steering wheel, stainless steel, covered with elk skin – 2017

ELECTRICAL SYSTEMS

Battery Banks:

- Domestic batteries AGM (LPC) 4 x 150 A - 2022.
- Engine battery AGM (LPC) 1 x 100 A - 2022.

Battery Chargers:

- 220 V / 12 V / 80 A (Mastervolt).

Alternators:

- 12 V / 80 A.
- 24 V / 130 Ah (Mastervolt) - 2019.

Generator:

- 3.5 kW, approx. 350 hrs (autumn 2023) - updated 2018.

Shore Power:

- 230 V with earth fault breaker and shore power cable.

Other Electrical:

- Solar panel, foldable 160W (Offgridtec) - 2019.
- Inverter 1,2 kW (Mastervolt).
- Battery control panel (Mastervolt MICC).

PLUMBING SYSTEMS

- Deck wash pump (sea water).

Fresh Water & Water Heating System:

- Water maker (Spectra) - fully serviced 2019 including new membrane - pickled 2021, not used since 2021.
- 12 V fresh water pump - 2019.
- 40 L hot water boiler (Isotherm) - 2019.

Bilge Pumps:

- Manual bilge pump.
- Electrical bilge pump, with level switch, auto/man.
- Electrical bilge pump, high capacity.

TANKAGE

Fuel:

- Approx. 395 L - tank cleaned and inspected 2018.

Fresh Water:

- Approx. 650 L - tank cleaned and inspected 2018.

Grey/Blackwater Holding Tanks:

- 2 x Holding tanks, approx. 60 L each, discharge to sea by gravity or by deck discharge.
- All sinks discharge directly over board by gravity.
- Showers discharge directly over board via 12 V pumps.

NAVIGATION EQUIPMENT

- Compass (Suunto) illuminated.
- 3 x Sailing data instruments, wind, speed, depth (Raymarine I70) - 2022.
- Sonar unit (Raymarine) - 2019.
- Plotter (Raymarine Axiom PRO 12) - 2019.
- Plotter (Raymarine Axiom 9 RVX) - 2019.
- Radar (Raymarine Quantum II) - 2019.
- Multi instrument (Raymarine I70) - 2019.
- Autopilot (Raymarine EV-400) with ACU400 - 2019.
- Autopilot instrument (Raymarine p70S) - 2019.
- Autopilot remote control (Raymarine RMK-10) - 2019.
- AIS (Raymarine AIS 700) - 2019.

- Navtex (Furuno NX300).
- COMMUNICATION, COMPUTER AND WEATHER SYSTEMS
- VHF (ICOM IC-M506) - 2019.
- VHF handheld (ICOM HM195) - 2019.
- Weather station (NASA MeteoMan) - 2019.
- Satellite phone (Sailor SC4000) with external antenna.
- Antenna (RR Ocean) for VHF, TV and FM.
- Wifi Booster (Red Box mini) with external antenna on 1st spreader - 2019.

DOMESTIC EQUIPMENT

Galley:

- Gas stove, 2-burners with oven (ENO), gas Solenoid (Truma) - 2017.
- Gas hoses - 2023.
- Fridge box.
- Freezer box – switchable to fridge - 2018.
- Single lever fresh water mixer.
- Foot pump seawater.
- Spare foot pump fresh water system.

Heads/Showers:

- 2 x Toilets, electric flush connected to fresh water system - 2016.
- Forward black water discharge pump - 2023.
- Washing machine (Kenny) - not used since 2022.
- Central vacuum cleaner (Beflexx 230 V) - 2021.
- Aft deck shower - 2022.

Heating & Ventilation:

- Diesel heating system, outlets in all cabins and heads (Webasto).
- 4 x Skylights.
- Aft cabin skylight - 2023.
- 10 x Portlights.
- 2 x Dorade type ventilator.
- 3 x Flat type ventilator on the bow - 2017 / 2021.

Entertainment:

- Stereo (Pioneer) two speakers inside, two speakers outside.

Lighting:

- Interior lighting (saloon, galley, heads) - 2022.

ACCOMMODATION

Summary of Accommodation:

- Sleep 5 persons in 2 cabins + 2 person in saloon sofas.
- Handmade interior of mahogany.
- Inspection hatches in floorboards.
- Headlining of cream white panels, mahogany trim.
- Upholstery, grey coloured - 2022.
- Carpet, curtains and decorative pillows - 2022.
- Skyscreen in all cabins.

- Hooks for different usage.
- In each cabin torches (LEDLENSER) - 2019.
- Smoke detector (ABUS) in the aft- and forward cabin - 2019.

Internal Layout:

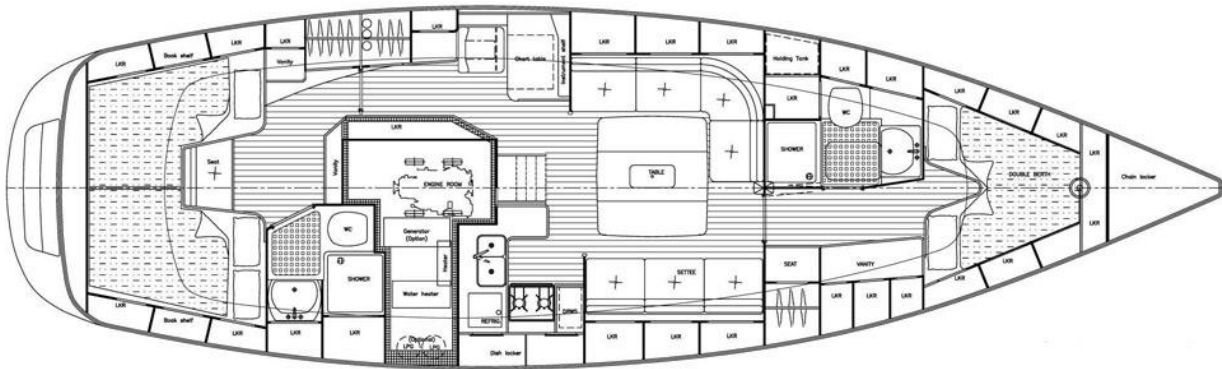

Description of layout from forwards:

Forward Cabin:

- V-berth.
- Plenty of storage in lockers and wardrobes.
- En suite heads/shower.

Forward Heads:

- Light and spacious heads with shower.

Saloon:

- 2 x Sofas.
- Solid foldable saloon table.
- Cupboards for storage.
- Lee cloth in starboard sofa.

Galley:

- Located to port of the entrance.

Navigation Area:

- Located to starboard of the entrance.

Passage Aft:

- Cupboards for storage.
- Entrance door to engine room.

Aft Cabin:

- Double berth to starboard.
- Single berth to port.
- Plenty of storage in lockers and wardrobes.
- En suite heads / shower.

Aft Heads:

- Light and spacious heads with shower.

DECK EQUIPMENT

Rig:

- Electric in-mast furling, replaced motor, gear and belt - 2020.
- Standing rigging - 2019.
- Furler for genoa (Selden Furlex 400S).
- Removable cutter stay.
- Hydraulic back stay adjuster (Navtec).
- Preventer line system - 2019.
- Deck light.
- Steaming light.
- Boom / Cockpit light LED - 2019.
- Tricolore lights LED - 2016.
- Anchor lights LED - 2016.
- Genoa and Main sail halyards (Dynema) - 2023.
- Genoa furling line and outhaul - 2022.
- Spinnaker Poole (aluminium).
- Deck gear (Lewmar).
- Line clutches (Lewmar and Spinlock).

Winches:

- 2 x Electrical Genoa winch (Lewmar 54).
- Electrical Main sheet winch (Lewmar 40).
- Manual Main sheet winch (Lewmar 40).
- 2 x Manual halyard winch at mast (Lewmar 40).

Sails:

- Mainsail (Hamel) - 2012.
- Genoa "(Hamel) - 2012.
- Genoa UV protection - 2022.
- Storm jib (Elvström) for cutter stay (lightly used).
- Gennaker (Elvström).
- Furler for gennaker.
- Removable bow sprit for gennaker.
- Mainsail (Elvström) - old.
- Genoa (Elvström) - old.

General:

- Fixed windscreen, opening mid window - 2020.
- Grab rail at the pedestal and outside the windscreen.
- High gloss varnished entrance and chart table with integrated teak grab rails - varnished 2022.
- Varnished cockpit table.
- Cockpit locker.
- G&T seats in pushpit - 2021.
- Pushpit teak fitting for outboard engine.
- Deck mounted navigation lights LED - 2016.

Anchoring & Mooring Equipment:

- Bow: 25 kg anchor (Rocna - 2018).
- Electrical windlass (Lewmar, Ocean).
- 56 m x 10 mm chain, galvanized.

- Stern: Bruce (15 kg).
- Ankarolina, mounted at a holder on the pushpit.
- Additional 20 kg anchor (Delta).
- 4 x Cleats (bow and stern) - 2023.
- 2 x Spring cleats - 2023.
- 2 x Cleats (at stern) - 2019.
- 5 x Mooring lines 10 m - 2016.
- 2 x Mooring lines 20 m - 2016.
- 6 x Fenders.
- Bow ladder.
- Boat hook.

Covers, Canvas & Cushions:

- Sprayhood (Rössy) - 2021.
- Sprayhood extension (Rössy) - 2021.
- Sprayhood extension short type - 2022.
- Bimini (Rössy) - 2022.
- Cover for steering pedestal (Hallberg Rassy) - 2021.
- Cockpit cushions.

Tender & Outboard:

- Davits (Båtsystem DV32-1, 100 kg/arm) - 2022.
- Crane for outboard.

SAFETY EQUIPMENT

- Life raft (Ocean safety ISO >24h), 6 persons, re-packed 2019, next service due 2022.
- Life raft release (Hammar) - 2017.
- Jack stays (Wichard) - 2018.
- Rescue Harness (SOSTECHNIC) - 2018.
- Additional (Wichard) pad eyes to clip onto the life line from the life vest - 2019.
- Rescue sling.
- Hansa line.
- EPIRB (Ocean Signal MOB 1) - 2018.
- Flares, rockets, fog (Comet) - 2018.

Fire-Fighting Equipment:

- 3 x Fire extinguisher manual (Jockel) foam, 2 kg - 2018.
- Fire extinguisher manual (Jockel) powder, 2 kg - 2018.
- Fire extinguisher manual (Jockel) Co2, 2 kg - 2018.
- Fire extinguisher automatic (Marinefire srl) Co2, 5 kg in engine room - 2018.
- Fire blanket.

KNOWN FAULTS/REMARKS:

- Fog horn does not work.

BERTHON

INTERNATIONAL YACHT BROKERS

Berthon UK

Bath Road
Lymington
Hampshire
SO41 3YL
England

00 44 (0)1590 679 222
brokers@berthon.co.uk
berthoninternational.com

Berthon France

Port de La Napoule
11 Avenue Henry Clews
F-06210
Mandelieu La Napoule
France

00 33 (0)4 93 63 66 80
brokers@berthonfrance.fr
berthonfrance.com

Berthon Scandanavia

Ångsvägen 16
473 33
Henån
Sweden

00 46 304 694 000
brokers@berthonscandinavia.se
berthonscandinavia.com

Berthon Spain

Carrer de Jeroni Pou 17A
07006
/ Edificio Dux –
Calle Porto Pi 4 - 1 07015
Palma de Mallorca

00 34 639 701 234
brokers@berthonspain.com
berthonspain.com

Berthon USA

40 Mary Street
Newport
Rhode Island
02840
USA

001 401 846 8404
sales@berthonusa.com
berthonusa.com

DISCLAIMER These particulars have been prepared from information provided by the vendors and are intended as a general guide to the yacht, their accuracy cannot be guaranteed by us. The purchaser should confirm details of concern to them by survey or engineer's inspection. The purchaser should also ensure that the purchase contract properly reflects their concerns and specifies details on which they may wish to rely.