



## Hallberg-Rassy 310 > ELLIDA



Price	SEK1,745,000 VAT paid
Location	Oxelösund, Sweden
Year	2011
LOA	30'11" / 9.42m
LWL	28'10" / 8.80m
Beam	10'5" / 3.18m
Draft	5'11" / 1.80m
Displacement	4,350kg / 9,590lb
Hull Material	GRP
Engine	1 x Yanmar 3YM20, 21hp
Builder	Hallberg-Rassy AB
Designer	German Frers
Accommodation	6 berths in 2 cabins & saloon



## BROKER'S COMMENTS

The Hallberg-Rassy 310 is an elegant, fast and easily maneuverable cruiser. The collaboration between German Frers and Hallberg-Rassy has been highly successful, resulting in a yacht with beautiful hull lines and a modern sail plan. As a result, 132 boats have been produced at the renowned yard in Ellös. This is a true Hallberg-Rassy model with all the typical details found on their larger models, such as a windshield, integrated rubbing strake, teak toe rail, and lead keel. Everything is packaged very tastefully in these 31 footer; they are a dream boat for sure!

Hallberg-Rassy is renowned for their ability to create ample space in their yachts, and this holds true for the Hallberg-Rassy 310 as well. The layout offers accommodation for up to 6 people, spread across two cabins and convertible sofas in the saloon. The interior is made of light mahogany, which, combined with good natural light, gives a surprisingly spacious feeling when you step down below. Directly to starboard at the foot of the companionway is the galley with ample storage and a stove with oven. Both the aft and forward cabins are generous in size and offer double berths and storage space. In the saloon, there is a table with folding sides and two sofas, and a protective mat covers the floor. The toilet is bright, spacious, and comes with a composite countertop. There are 11 portlights and 4 deck hatches aboard, all of which are openable and provide excellent ventilation.

The cockpit offers ample space for the whole crew, with easy access to the bathing platform through the aft opening, which can be sealed if required. The Hallberg-Rassy 310 is not only visually striking with its generous interior and cockpit spaces but is also a proven performer, triumphing in its class at the prestigious Tjörn Runt sailing race.

This Hallberg-Rassy 310, ELLIDA has lived her life on the east coast and is still sailed by her first owner. Service and winter storage have been provided by Oxelösunds Båtvärv, which, along with the brackish waters of the Baltic Sea, has kept her in very good condition. ELLIDA boasts an equipment level typically found on larger yachts. She features both a furling mast, bow thruster, and teak deck. Tiller steering not only provides a delightful sailing sensation, but in the raised position, it also offers a cockpit with superior size. This Hallberg-Rassy 310 is an ideal luxury cruiser for the Swedish archipelago, but she can take you much farther if desired.

### Key Facts:

- Furling mast from Selden Mast.
- Yanmar 3YM20 engine.
- 6 berths in 2 cabins + saloon.
- Tiller steering.
- Bow thruster.
- Bowsprit for gennaker, removable.
- Sprayhood with extension for cockpit.
- Bathing platform with teak.
- Teak in cockpit and deck.
- Raymarine plotter.
- Autopilot.
- Heater Webasto.
- Inverter.
- Winter stored indoor at service yard.
- Professional service with full documentation.
- One owner.

Explore more photos here: <https://berthonscandinavia.se/en/yachts-for-sale/hallberg-rassy-310-ellida/>

## CONSTRUCTION

*RCD Status: The yacht conforms with the essential safety requirements of Directive 94/25EC or RCDII (2013/53/EU as appropriate (Recreational Craft Directive) and is categorised A – “Ocean” (or Cat B – whichever is appropriate)*

### Hull, Deck & Superstructure Construction:

- White hull with blue trim lines.
- Hull and deck in GRP, sandwich construction.
- Integrated rubbing strake, brass stripe.
- Teak toerail.
- Windscreen, openable mid section.
- Teak in cockpit, on deck and bathing platform.

### Keel & Rudder:

- Fin keel with bulb, lead.
- GRP rudder with stainless steel rudderstock and self-aligning bearings.

## MACHINERY

### Engine & Gearboxes:

- Yanmar 3YM20, 21hp. Approx. 800 hours (display out of order).

### Propulsion & Steering:

- Tiller steering.
- Tiller extension (Spinlock).
- S-drive.
- Folding propeller, 3-blade (Gori).
- Bow thruster, 3hp (Sleipner).

## ELECTRICAL SYSTEMS

### Battery Banks:

- 2 x 6 V Deep cycle battery 240 Ah (Trojan) -2018.
- 1 x 12 V start battery 80 Ah -2018.
- 2 x 6 V bow thruster Deep cycle battery 240 Ah (Trojan) -2018.
- Battery monitor, Masterview (Mastervolt).

### Battery Chargers:

- Charger Mass Combi/Inverter 230V / 12V/ 1200 / 60A (Mastervolt).

### Alternators:

- Alternator 12V/125A.

### Shore Power:

- 220V shore power system with earth fault breaker.

**Other Electrical:**

- DC control panel.
- 12V outlets.
- 230V outlets.
- Isolation transformer (Mastervolt).
- Solar panel 22 W.

**PLUMBING SYSTEMS****Fresh Water & Water Heating System:**

- Total hot water capacity of 25 litres.

**Bilge Pumps:**

- Manual bilge pump.
- Electric bilge pump.

**TANKAGE****Fuel:**

- Total capacity of 100 litres.

**Fresh Water:**

- Total capacity of 200 litres.

**Grey/Blackwater Holding Tanks:**

- Total holding tank capacity of 50 litres, deck and sea evacuation.

**Gas:**

- Gas bottle, 6kg.

**NAVIGATION EQUIPMENT**

- 1 x Compass with light (Silva).
- Plotter A70 with GPS antenna (Raymarine).
- 2 x Multi instrument FI-50 (Furuno); speed, depth, log.
- 1 x Wind instrument FI-50 (Furuno).
- 1 x Multi instrument FI-50 at nav station (Furuno).
- Compass at companionway.
- Autopilot for tiller with control unit (Raymarine).
- VHF Ray55E (Raymarine).
- VHF antenna.

**DOMESTIC EQUIPMENT****Galley:**

- Stove with 2 burners and oven (ENO).
- Double sink with water tap.
- Pressurized water.
- Fridge.
- Foot pump for sea water.
- Hand pump for fresh water.

**Heating & Ventilation:**

- Diesel heater incl 4 outlets (Webasto Airtop 3900).
- 4 x Skylights.
- 11 x Portlights.
- 2 x Dorado vents.

**Entertainment:**

- CD/Radio (Pioneer), 2 x speakers in saloon.

**Lighting:**

- Reading Lights.
- Night lights over navigation and galley.

**ACCOMMODATION****Summary of Accommodation:**

- 6 berths in 2 cabins and saloon.
- Interior in mahogany, matt silk finish.
- Blue cushions.
- Floorboards with holly strips, inspection hatches.
- 4-6 berths, owner's cabin, guest cabin and saloon.
- Heads with shower.
- L-sofa on port side, centerline foldable leaf table.
- Sofa port side.
- White inner ceiling, mahogany strips.
- Spotlights.
- Carpets, beige.
- Blinds with mosquito net for skylights (Ocean Air).

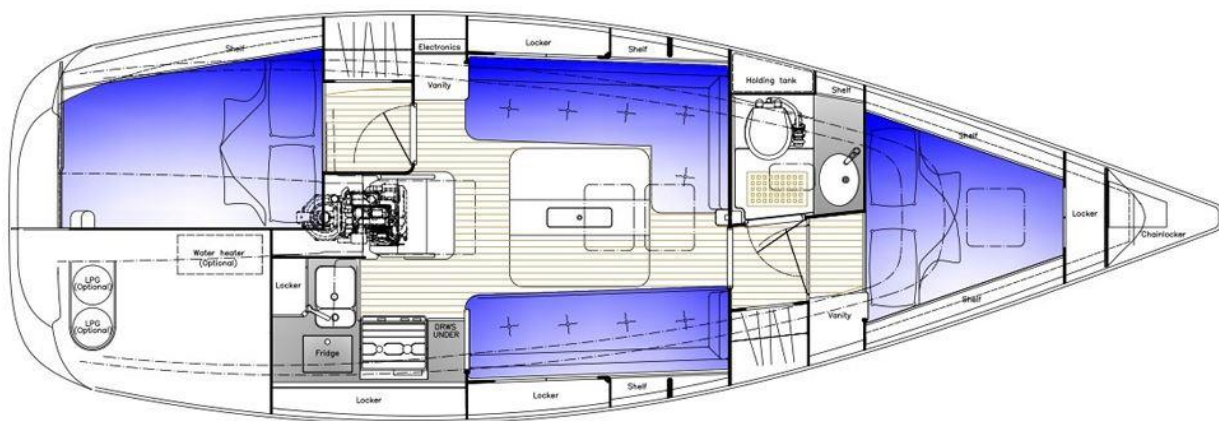
**Internal Layout:****Description of layout from forwards:**

- Owner's cabin with double V-berth.
- Wardrobe and cupboard.
- Heads with shower.
- Spacious saloon with ample of storage.
- Sofa convertible to berths, lee cloths.
- Centerline foldable saloon table with wine rack.



- Navigation area port side.
- L-shape galley on starboard side.
- Aft cabin with double berth.
- Wardrobe, shelf and storage under bed.

## DECK EQUIPMENT

### Rig:

- Fractional 2-spreader mast (Seldén Mast).
- In-mast furling.
- Furling system forestay, below deck (Furlex TD).
- Rodkick with gas spring.
- Isolated backstay.
- Backstay bridle with block system.
- Gennaker equipment.
- Windex.
- LED 3-col/ anchor light (Aqua Signal).
- Deck light.
- Spinnaker pole, telescope.
- Aluminium rigging screw covers.

### Winches:

- 2 x Genoa winch 45CST (Lewmar).
- 2 x Halyard winch 30CST (Lewmar).

### Sails:

- Furling main, EPEX-laminate (Elvström).
- Furling jib, EPEX-laminate (Elvström).
- Gennaker with snuffer (Elvström).

### General:

- Grab handles on coach roof.
- Safety/swim ladder, stainless steel.
- Removable main sheet track.
- Genoa tracks, adjustable from cockpit.
- Flag pole.

### Anchoring & Mooring Equipment:

- 6 x Mooring cleats, stainless steel.
- 6 x Mooring lines.
- 6 x Fenders.
- Bow: Electric windlass with Delta anchor 16kg and chain 40m (Lewmar).
- Stern: Breeze anchor 10kg with fitting at pushpit, Ankarolina.

### Covers, Canvas & Cushions:

- Sprayhood with extension, cockpit canopy beige.
- Cockpit table, foldable (Lagun).
- Storage locker starboard side.

### Tender & Outboard:

- Outboard bracket on pushpit.

## **SAFETY EQUIPMENT**

- Horseshoe bouy with holder.
- Pad eyes for life line in cockpit.

### **Fire-Fighting Equipment:**

- 2 x Fire extinguishers.

# BERTHON

INTERNATIONAL YACHT BROKERS

**Berthon UK**

Bath Road  
Lymington  
Hampshire  
SO41 3YL  
England

0044 (0)1590 679 222  
brokers@berthon.co.uk  
berthoninternational.com

**Berthon Scandinavia**

Ängsvägen 12  
473 33  
Henån  
Sweden

0046 304 694 000  
brokers@berthonscandinavia.se  
berthonscandinavia.com

**Berthon Spain (Yacht Sales)**

Edificio Reina Constanza  
Calle Porto Pi 8 - 8B  
07015  
Palma de Mallorca  
Spain

0034 871 044 659  
brokers@berthonspain.com  
berthonspain.com

**Berthon Spain (Yacht Services)**

Carrer de Can Rius 14 - Local 1  
07610  
Palma de Mallorca  
Spain

0034 971 415 441  
services@berthonspain.com  
berthonspain.com

**Berthon USA**

40 Mary Street  
Newport  
Rhode Island  
02840  
USA

001 401 846 8404  
sales@berthonusa.com  
berthonusa.com

*DISCLAIMER These particulars have been prepared from information provided by the vendors and are intended as a general guide to the yacht, their accuracy cannot be guaranteed by us. The purchaser should confirm details of concern to them by survey or engineer's inspection. The purchaser should also ensure that the purchase contract properly reflects their concerns and specifies details on which they may wish to rely.*