



Najad 440 CC > **ONLY BLUE**



Price	€349,000 VAT paid
Location	Stockholm, Sweden
Year	2006
LOA	44'4" / 13.5m
LWL	39'8" / 12.1m
Beam	13'3" / 4.03m
Draft	6'11" / 2.1m
Displacement	14,000kg / 30,865lb
Hull Material	GRP
Engine	1 x Volvo Penta D2-75, 75hp
Builder	Najadvarvet AB
Designer	Judel/Vrolijk & Co
Accommodation	4 berths in 2 cabins



BROKER'S COMMENTS

The aim of the successful design of the Najad 440 CC was to create a luxury, highly exclusive and superb sailing yacht, capable of being handled in safety by a crew of two persons.

The outcome from the combination of naval architect Judel/Vrolijk & Co, interior designer Rhodes Young and Najadvarvets craftsmen, was a ground breaking, exceptional "world class" yacht. The Najad 440 is equally suited for ocean adventures, as to the gentler life of coastal cruising and island hopping.

The Najad 440 comes in two different versions, AC (aft cockpit) and CC (centre cockpit). This Najad 440 ONLY BLUE is the CC version, delivered in 2006. The yacht offers a well-protected cockpit ideal for ocean sailing where all sail handling and instruments are always close by. The fixed windscreen and sprayhood gives great protection in any sailing conditions.

The interior layout offers a large owner's aft cabin with double berths and en suite toilet with shower. The forward guest cabin also offers a double berth, en suite toilet with shower and plenty of storage space. A sea going longitude galley is located to port of the entrance extending aft wards and the navigation table with a comfortable seat is located directly to starboard of the entrance. The saloon has an L-shaped sofa to port and a straight sofa to starboard. A superb layout for an ocean-going yacht!

The interior is made of selected mahogany with floorboards in Jatoba and light-coloured upholstery.

Najad 440 ONLY BLUE was originally sold in France. In 2014, she was bought by a Swedish couple who sailed the yacht back to her original "home" on the Swedish west coast. The current third owner couple have enjoyed ONLY BLUE since 2017. She has been used for family sailing in Scandinavia, mainly in the Stockholm archipelago. The current owners have taken very good care of ONLY BLUE and she has had several upgrades during recent years.

Key Facts:

- Two cabins with two double berths.
- In- mast furling.
- Electric furling for genoa – 2018.
- Manual furling for jib.
- Mainsail – 2018.
- Genoa – 2018.
- Jib – 2019.
- Electric genoa winches.
- Electric windlass aft and forward.
- Sprayhood – 2018.
- Cockpit tent – 2018.
- Volvo D2-75 – 2019.
- 3-blade folding propeller – 2018.
- Bow thruster – 2021.
- Diesel generator.
- Isolation transformer.
- TV 28" – 2017.
- Professionally maintained.
- Copper coat antifouling – 2019.

Explore more photos here: <https://www.berthoninternational.com/yacht-sales-brokerage/yachts-for-sale/najad-440-cc-only-blue/>

CONSTRUCTION

RCD Status: The yacht conforms with the essential safety requirements of Directive 94/25EC or RCDII (2013/53/EU as appropriate (Recreational Craft Directive) and is categorised A – “Ocean”

Hull, Deck & Superstructure Construction:

- White hull with blue trim lines.
- Hull in sandwich construction with divinycell core material.
- Deck in sandwich construction with divinycell core material.
- The hull and deck are reinforced in exposed areas.
- The main bulkheads are laminated to the hull and deck.
- Teak on deck, coach roof, cockpit and swim platform.
- Teak capping with stainless steel protection rail.
- Antifouling (Copper coat) – 2019.
- Hull and deck polished – 2024.

Keel & Rudder:

- Spade rudder.
- Cast iron keel with lead bulb.
- Acid resistant stainless steel bolts.
- Spade rudder with 2 x bearings including lower spherical bearing.

MACHINERY

Engine & Gearboxes:

- 1 x Volvo Penta D2-75, 75hp.
- Sound insulated engine room.
- 2 x Fuel pre filters.
- Sail drive (Volvo Penta).

Maintenance & Performance:

- Engine hours approx 596 (2019)
- Engine serviced annually.

Propulsion & Steering:

- Bow thruster, retractable – 2021.
- 3-blade folding propeller – 2018.
- Rod steering system (Lewmar).
- Steering wheel, stainless steel.
- Steering wheel covered with skin – 2018.

ELECTRICAL SYSTEMS

Voltage Systems:

- 12V.
- 24V.
- 230V.

Battery Banks:

- Domestic batteries, AGM, 24V / 360Ah.
- Engine battery 12V / 75Ah.

Battery Chargers:

- Inverter / battery charger 230V / 24V / 3000W / 70A (Victron).
- Battery charger 230V / 12V / 8A (SBC 100).

Alternators:

- Alternator 12V / 60A.
- Alternator 24V / 80A.

Generator:

- Diesel generator approx. 160 hrs (Fisher Panda).

Shore Power:

- 220 V shore power system, outlets in all cabins, ground fault circuit breaker, fuse box.
- Shore cable, 20m – 2020.

Other Electrical:

- Phoenix multi control.
- Isolation transformer.

PLUMBING SYSTEMS**Fresh Water & Water Heating System:**

- Pressurized hot and cold water system.
- Hot water boiler 40L – 2021.

Bilge Pumps:

- Manual bilge pump.
- Electrical bilge pump, auto/man.
- Electrical bilge pump, high capacity (Rule).

TANKAGE**Fuel:**

- Fuel approx. 425L (stainless steel tank).

Fresh Water:

- Water approx. 525L (stainless steel tanks).

Grey/Blackwater Holding Tanks:

- 2 x Holding tanks approx. 60L / tank (stainless steel tanks) deck and sea evacuation.

NAVIGATION EQUIPMENT

- Compass, illuminated.
- Speed instrument (Raymarine ST60).
- Depth instrument (Raymarine ST60).
- Wind instrument (Raymarine ST60).

- Close haul instrument (ST 290).
- Graphic instrument (ST 60).
- Plotter (Raymarine E 120).
- Radar (Raymarine).
- Autopilot with mamba drive, course computer and gyro (Raymarine ST 6001 plus).
- Autopilot wireless remote control.
- AIS.
- Computer screen in Nav station.
- Navtex (Furuno NX300).
- GPS (Furuno GP 32).
- Barometer (digital).
- VHF (Ray 240 E dual) at navigation table and in cockpit.
- 2 x VHF speakers.
- Antenna for VHF, TV and FM (RR).

DOMESTIC EQUIPMENT

Galley:

- Gas stove, 2-burners with oven (SMEV).
- Gas valve remote control.
- Gas alarm.
- Gas hoses – 2020.
- Fridge box 92 L (Isotherm SP).
- Micro.
- Corian worktop.
- Single lever freshwater mixer.

Heads/Showers:

- Electric toilet (aft).
- Manual toilet (forward).
- 2 x Shower drain pumps.

Heating & Ventilation:

- Diesel heater (Eberspacher) outlets in all cabins, heads and cockpit.
- 6 x Dorade type ventilators with stainless steel protection bars.
- 5 x Skylights.
- 11 x Portlights (opening type in galley, heads, forward- and aft cabin).
- Ventilation louvers in the companionway hatch.

Entertainment:

- Stereo (Alpine).
- TV 28" – 2017.
- TV antenna – 2020.

Lighting:

- Ceiling lights LED with dimmer function.

ACCOMMODATION

Summary of Accommodation:

- Sleep 4 people in two cabins.

- Handmade interior of mahogany and Jatoba.
- Inspection hatches in floorboards.
- Headlining of cream white covered panels.

Internal Layout:

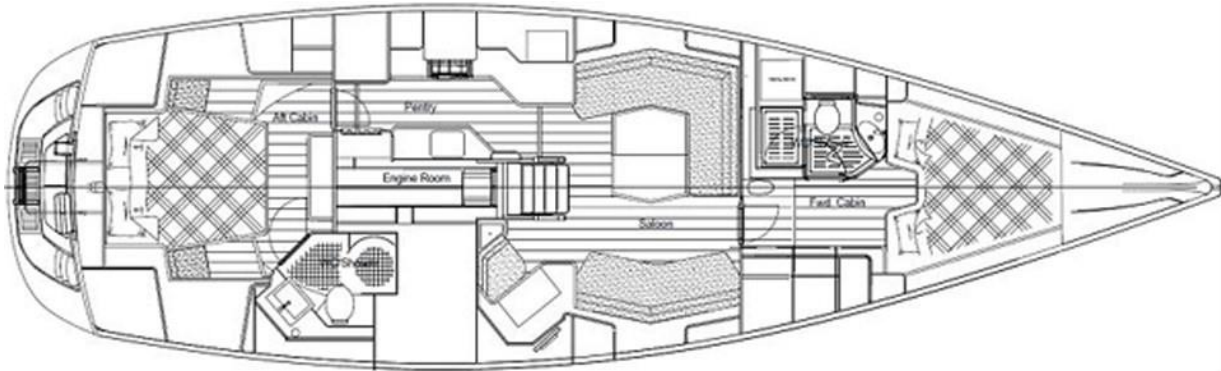

Description of layout from forwards:

Forward Cabin:

- Forward cabin with en suite heads/shower.
- Double berth.
- Wardrobe, cupboards and shelves.

Forward Heads / Shower:

- Light and spacious heads/shower compartment.
- Corian bench top and floorboard.
- Cupboards for storage.

Saloon:

- Exclusive entrance stair with shaped footsteps and mahogany handrail.
- L-shaped sofa to port.
- Sofa to starboard.
- Saloon table.
- Plenty of cupboards and storage.

Navigation Area:

- Navigation area to starboard of the entrance.
- Comfortable seat.
- Navigation table.
- Drawers.

Galley:

- The galley is located to port of the entrance stair, extending aft wards.
- Plenty of storage spaces, cupboards, drawers, dry storage.
- Corian worktop.

Aft Cabin:

- Spacious aft cabin with en suite heads/shower.
- Double berth.
- Seat.

- Wardrobe, cupboards and drawers.

Aft Heads / Shower:

- Light and spacious heads/shower compartment.
- Corian bench top and floorboard.
- Cupboards for storage.

DECK EQUIPMENT

Rig:

- In mast furling mast, manoeuvred from cockpit (Seldén).
- Electrical Furlex for genoa – 2018.
- Electric motor for furlex – 2024.
- Manual Furlex for jib.
- Back stay adjuster, hydraulic (Holmatro).
- Rodkick with gas damper (Seldén).
- Aluminium rigging screw protection.
- Deck lights in front of mast.
- Boom / cockpit light.
- Windex.
- 2 x Flag halyards.

Winches:

- 2 x Electrical genoa winch, stainless steel (Andersen 58 STE).
- 2 x Main sheet winch, stainless steel (Andersen 40 ST).
- 2 x Halyard winch, stainless steel (Andersen 40 ST).

Sails:

- Furling Mainsail (UK Carbon) – 2018.
- Furling Genoa (UK Carbon, UV-protection) – 2018.
- Furling Jib (Gransegel, crosscut, dacron, UV-protection) – 2019.
- Gennaker.

General:

- High gloss varnished entrance and chart table with integrated teak grab rails.
- Varnished cockpit table.
- Stainless steel grab rail at the pedestal.
- Fixed windscreen.
- 2 x Stainless steel grab rails outside the windscreen.
- Cockpit locker.
- Pushpit teak fitting for outboard engine.
- Aft deck shower.
- Safety/Swim ladder.
- Integrated seats in pushpit.
- Crane for outboard.

Anchoring & Mooring Equipment:

- Bow: Electrical windlass, below deck mounted, 25kg Spade anchor, 40m x 10mm chain.
- Hand control – 2023.
- Stern: Electric windlass, Bruce anchor, 30m lead line – 2018.
- 4 x cleats, stainless steel.

- 2 x spring cleats, stainless steel.
- 2 x Lifeline gates.
- 4 x Mooring lines.
- 4 x Fenders.
- Bow ladder, foldable, needs service.
- Boat hook.

Covers, Canvas & Cushions:

- Sprayhood with integrated grabrail – 2018.
- Sprayhood extension – 2018.
- Cockpit cushions.
- Frames for bimini.

SAFETY EQUIPMENT

- Life raft (Viking 4UKSL), latest service – 2019.
- Rescue sling.
- Horseshoe buoy with light.
- Jack stays in cockpit.
- EPIRB (McMurdo), service need.

Fire-Fighting Equipment:

- 3 x Fire extinguishers.

BERTHON

INTERNATIONAL YACHT BROKERS

Berthon UK

Bath Road
Lymington
Hampshire
SO41 3YL
England

0044 (0)1590 679 222
brokers@berthon.co.uk
berthoninternational.com

Berthon Scandinavia

Ängsvägen 12
473 33
Henån
Sweden

0046 304 694 000
brokers@berthonscandinavia.se
berthonscandinavia.com

Berthon Spain (Yacht Sales)

Edificio Reina Constanza
Calle Porto Pi 8 - 8B
07015
Palma de Mallorca
Spain

0034 871 044 659
brokers@berthonspain.com
berthonspain.com

Berthon Spain (Yacht Services)

Carrer de Can Rius 14 - Local 1
07610
Palma de Mallorca
Spain

0034 971 415 441
services@berthonspain.com
berthonspain.com

Berthon USA

40 Mary Street
Newport
Rhode Island
02840
USA

001 401 846 8404
sales@berthonusa.com
berthonusa.com

DISCLAIMER These particulars have been prepared from information provided by the vendors and are intended as a general guide to the yacht, their accuracy cannot be guaranteed by us. The purchaser should confirm details of concern to them by survey or engineer's inspection. The purchaser should also ensure that the purchase contract properly reflects their concerns and specifies details on which they may wish to rely.