



## Najad 380 > ENFIN



|               |                               |
|---------------|-------------------------------|
| Price         | SEK2,395,000 VAT paid         |
| Location      | Henån, Orust - Sweden         |
| Year          | 2005                          |
| LOA           | 37'8" / 11.55m                |
| LWL           | 32'4" / 9.90m                 |
| Beam          | 11'9" / 3.65m                 |
| Draft         | 6'4" / 1.95m                  |
| Displacement  | 9,300kg / 20,502lb            |
| Hull Material | GRP                           |
| Engine        | 1 x Yanmar 4JH4-E, 54hp       |
| Builder       | Najadvarvet AB                |
| Designer      | Judel/Vrolijk & Co            |
| Accommodation | 7 berths in 2 cabins + saloon |



## BROKER'S COMMENTS

The Najad 380 is a sleek and elegant sailing yacht crafted by the renowned shipyard in Henån. Building on the success of the Najad 373, the Najad 380 is widely regarded as one of the yard's most successful and popular models. This reputation is well-earned, thanks to the exceptional comfort on board and the consistently high quality that defines this cruising vessel. Designed by Judel/Vrolijk & Co, Najadvarvet has upheld its esteemed reputation by creating an outstanding center cockpit yacht. The bulkheads are securely laminated to the hull and deck, providing maximum strength and contributing to the yacht's superior speed and performance. The Najad 380 is designed for comfortable sailing, whether you are cruising along the coast or navigating the open sea.

The boat features a sandwich construction with Divinycell as the core material, ensuring both durability and strength. It has a deep bilge, a lead keel, and a skeg rudder for enhanced stability and control. The interior layout is thoughtfully designed, offering a spacious salon with two sofas, a navigation station, and a well-lit toilet. The longitudinal galley leads to a comfortable Owner's cabin aft, complete with a 2+1 berth solution. At the bow, there is a V-berth providing cozy accommodation for two guests. While at sea, the well-protected center cockpit with a fixed windscreen and spray hood offers comfort and security, especially in challenging weather conditions. The Najad 380 boasts a consistently high level of equipment, and the exquisite woodwork, for which Najad is renowned, will continue to please sailors for years to come.

The Najad 380, ENFIN has had three owners, all of whom have taken excellent care of her. The current owner has upgraded her with a self-tacking jib track and a new jib. She is also equipped with a new Raymarine plotter and AIS. ENFIN has a high level of equipment, including everything you need to make life on board comfortable, such as an electric toilet, heater, and cockpit canopy. The furling mast and self-tacking jib track make sail handling incredibly easy, and in tight harbors, you can handle every situation smoothly with the help of a powerful bow thruster and strong engine.

Najad 380 has everything that characterizes an Orust boat and ENFIN is a very nice example, she is absolutely worth a visit. Welcome to book a viewing.

### Key Facts:

- Furling mast from Selden Mast.
- Jib with ST-track -2021
- Yanmar 54hp engine.
- Bow thruster.
- Gennaker with snuffer.
- Bowsprit with teak, ladder integrated.
- Teak on deck, superstructure, bathing platform and cockpit.
- 5 + 2 berths, two cabins + saloon.
- Solar panel.
- New plotter from Raymarine – 2023.
- AIS – 2022.
- Heater.
- Electric toilet.
- Cockpit canopy.
- Professional service and maintenance at service yard.
- Indoor winter storage.

Explore more photos here: <https://berthonscandinavia.se/en/yachts-for-sale/najad-380-enfin/>

## OWNER'S COMMENTS

This is my fourth sailboat, following two Hallberg-Rassys and one Najad. Without a doubt, this is the best one we've owned. It sails beautifully and is impressively fast. The boat handles exceptionally well in all weather conditions and is easy to manage, both at sea and in harbor. We've primarily sailed her along the Swedish West Coast, usually with just the two of us, but also with family and friends on board. The Najad 380 is a perfect cruising boat with a good layout and safe cockpit. We hope she will find a new owner who will take good care of her.

## CONSTRUCTION

*RCD Status: The yacht conforms with the essential safety requirements of Directive 94/25EC or RCDII (2013/53/EU as appropriate (Recreational Craft Directive) and is categorised A – "Ocean"*

### Hull, Deck & Superstructure Construction:

- White hull with red trimlines.
- Hull and deck in GRP.
- Teak on deck, superstructure, cockpit and at bathing platform.
- Teak vacuum glued.
- Bowsprit in stainless steel with teak step and integrated ladder.
- Integrated rubbing strake, brass.
- Deep bilge.

### Keel & Rudder:

- Lead keel.
- Skeg hang rudder.

## MACHINERY

### Engine & Gearboxes:

- 1 x Yanmar 4JH4-E, 54hp.
- Shaft drive, centaflex coupling.

### Maintenance & Performance:

- Engine hours approx. 1500 hours (display no function).
- Annual engine service.

### Propulsion & Steering:

- 3-blade folding propeller (Flex-o-Fold).
- Bow thruster (Max Power).
- Stainless steel steering wheel with elk skin.

## ELECTRICAL SYSTEMS

### Voltage Systems:

- 12V DC domestic system.
- DC control panel.
- 230V outlets.
- 12V outlets.

**Battery Banks:**

- 12V Service batteries 3x120Ah – 2016.
- 12V Start battery 1x 75Ah.

**Battery Chargers:**

- Battery charger 12V/ 40A.

**Alternators:**

- Alternator 12V / 80A.

**Shore Power:**

- 220V shore power system with earth fault breaker and cable.

**Other Electrical:**

- Battery monitor system.
- Solar panel.

**PLUMBING SYSTEMS****Fresh Water & Water Heating System:**

- Water heater 20L (Isotemp).

**Bilge Pumps:**

- Electric bilge pump.
- Manual bilge pump.

**TANKAGE****Fuel:**

- Total fuel capacity, 325L (stainless steel).

**Fresh Water:**

- Total water capacity, 400L (stainless steel).

**Grey/Blackwater Holding Tanks:**

- Septic tank, 55L (stainless steel).
- 3-way valve, deck and sea evacuation.
- Level gauge, ultrasound (Gobius).

**NAVIGATION EQUIPMENT**

- Compass with light.
- Plotter 9" (Raymarine Axiom Pro) – 2023.
- Autopilot incl control unit ST6001+ (Raymarine).
- 1 x Speed ST60 (Raymarine).
- 1 x Depth ST60 (Raymarine).
- 1 x Wind ST60 (Raymarine).
- AIS transponder class B, AIS 700 (Raymarine) – 2022.
- VHF Ray 54E (Raymarine).
- Antenna for VHF, FM & TV.

## DOMESTIC EQUIPMENT

### Galley:

- 2-burner stove with oven.
- 1 x Fridge 92L.
- Double sink with water faucet, hot and cold water.
- Foot pump for fresh water.
- Laminate worktop.
- Remote gas switch.

### Heads/showers:

- 1 x Heads with shower.
- Electric toilet.
- Basin with Corian worktop.

### Heating & Ventilation:

- Diesel heater (Eberspächer), outlets in all cabins, heads and cockpit.
- Dorade ventilators with stainless steel protectors.

### Entertainment:

- Radio/CD with speakers in saloon and cockpit (Pioneer).

### Lighting:

- Reading lights in cabins and saloon.

## ACCOMMODATION

### Summary of Accommodation:

- 7 berths in 2 cabins and saloon.
- Interior in varnished mahogany.
- Blue cushions.
- Inspection hatches in floorboards.
- White ceiling with mahogany ribs.
- Floorboards in varnished teak, holly stripes.
- Wet locker.
- Ship clock & barometer.
- Carpets.
- Bed mattresses in forward and aft cabin.
- Curtains for all portlights.

## Internal Layout:

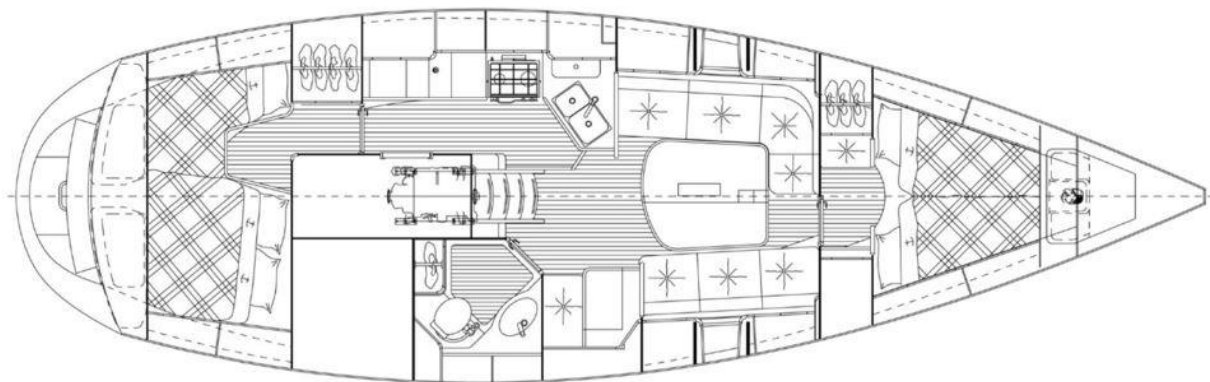

### Description of layout from forwards:

- Forward cabin with double V-berth, seat and wardrobes.
- L-sofa on port side and sofa on starboard.
- Centerline table with foldable sides and bar lockert.
- Navigation area with work top, facing forward on starboard side.
- Heads with shower on starboard side of entrance.
- Longitudinal kitchen on port side with ample of storage.
- Owner's cabin aft with 2+1 berth.
- Wardrobe and cupboards, ample of storage space.

## DECK EQUIPMENT

### Rig:

- Fractional mast with 2 pairs of spreaders (Seldén Mast).
- Furling mast, cockpit operated.
- Forstay furling system (Furlex).
- Self-tacking track -2021
- Rodkick with gas spring (Selden Mast).
- Manual backstay tensioner (Selden Mast).
- Boom preventer (Gybe Buster).
- Gennaker equipment.
- Windex.
- 3-color and anchor light.
- Deck light.
- Radar reflector.

### Winches:

- 2 x Genoa winches (Andersen 52 ST).
- 2 x Halyard winches at mast (Andersen 12 ST).
- 2 x Main sheet winches (Andersen 28 ST).

### Sails:

- Main sail, DC laminate (UK Sailmakers).
- Jib Self-tacking, laminate (Elvström Sails) – 2021.
- Genua, DC laminate (UK Sailmakers).
- Gennaker.
- Snuffer.

**General:**

- High gloss varnished companionway, chart tables and instrument panel.
- Genoa tracks with control lines to cockpit.
- Outhaul to cockpit.
- Guard rail gates.
- Cockpit table.
- Shower in cockpit, hot & cold water.
- Gloveboxes in cockpit.
- Large cockpit locker.
- G&T seats at pushpit.
- 2 x aft lockers.
- Protection rails at mooring cleats.

**Anchoring & Mooring Equipment:**

- Electric windlass in bow (Lofrans 1000W), anchor 15kg (Bruce), 40m 8mm chain.
- Anchor in stern, Bruce 15kg anchor with line.
- Mid ship cleats.
- 6 x Mooring cleats.
- 6 x Mooring lines.
- 6 x Fenders.

**Covers, Canvas & Cushions:**

- Sprayhood with extension.
- Cockpit canopy.

**Tender & Outboard:**

- Outboard bracket.

**SAFETY EQUIPMENT**

- Jack stay fitting on deck.
- Life buoy.
- Pad eyes for safety harness in cockpit.

**Fire-Fighting Equipment:**

- 2 x Fire extinguishers.

# BERTHON

INTERNATIONAL YACHT BROKERS

**Berthon UK**

Bath Road  
Lymington  
Hampshire  
SO41 3YL  
England

0044 (0)1590 679 222  
brokers@berthon.co.uk  
berthoninternational.com

**Berthon Scandinavia**

Ängsvägen 12  
473 33  
Henån  
Sweden

0046 304 694 000  
brokers@berthonscandinavia.se  
berthonscandinavia.com

**Berthon Spain (Yacht Sales)**

Edificio Reina Constanza  
Calle Porto Pi 8 - 8B  
07015  
Palma de Mallorca  
Spain

0034 871 044 659  
brokers@berthonspain.com  
berthonspain.com

**Berthon Spain (Yacht Services)**

Carrer de Can Rius 14 - Local 1  
07610  
Palma de Mallorca  
Spain

0034 971 415 441  
services@berthonspain.com  
berthonspain.com

**Berthon USA**

40 Mary Street  
Newport  
Rhode Island  
02840  
USA

001 401 846 8404  
sales@berthonusa.com  
berthonusa.com

*DISCLAIMER These particulars have been prepared from information provided by the vendors and are intended as a general guide to the yacht, their accuracy cannot be guaranteed by us. The purchaser should confirm details of concern to them by survey or engineer's inspection. The purchaser should also ensure that the purchase contract properly reflects their concerns and specifies details on which they may wish to rely.*