



## Hallberg-Rassy 40 > IDUNN



Price	€300,000 VAT paid
Location	Åbo/Nådendal, Finland
Year	2008
LOA	40'8" / 12.4m
LWL	34'9" / 10.6m
Beam	12'6" / 3.82m
Draft	6'6" / 1.99m
Displacement	10,000kg / 22,046lb
Hull Material	GRP
Engine	1 x Volvo Penta D2-55, 55hp
Builder	Hallberg-Rassy
Designer	German Frers
Accommodation	4+1 berth in 2 cabins & saloon



## BROKER'S COMMENTS

The Hallberg-Rassy 40 is a robust and versatile bluewater cruiser, designed for long-distance voyaging with a blend of reliability, performance, and comfort. Developed by renowned designer German Frers, this model delivers excellent sailing characteristics, featuring a balanced sail plan and a deep fin keel that enhances stability and control. The centre cockpit layout includes Hallberg-Rassy's iconic fixed windshield, providing both protection from the elements and excellent visibility. Teak decking, high-backed seating, and a well-organized cockpit contribute to the safety and comfort required for extended passages. Electric in-mast furling for the mainsail and a roller-furling genoa enable easy sail handling, especially for a short-handed crew.

Constructed with durability in mind, the Hallberg-Rassy 40's hull is built using a hand-laid isophthalic polyester gelcoat and resin for superior strength and water resistance. A well-engineered grid system distributes loads from the keel and mast step throughout the hull, ensuring rigidity and seaworthiness. Above the waterline, Divinycell PVC foam core enhances insulation and impact resistance. The deck is similarly cored with Divinycell, reinforced at hardware mounting points for additional strength.

This model has received worldwide acclaim, winning notable awards such as European Yacht of the Year, Cruising World's Boat of the Year, and a spot in Sail Magazine's Top Ten, highlighting its exceptional design, quality, and performance.

Below deck, the interior is crafted with satin-finished mahogany, showcasing Hallberg-Rassy's renowned craftsmanship and featuring curved laminations in the trim and structural components. Ample storage is thoughtfully integrated throughout the vessel, providing practical solutions for extended cruising. The saloon includes a versatile L-shaped sofa with a foldable table and two comfortable armchairs. The aft cabin provides a spacious double berth and good storage options, while the forward cabin offers a v-berth with convenient access to additional storage. The well-equipped galley is designed for long-range cruising and the large head with a separate shower is positioned forward of the mast bulkhead.

The Hallberg-Rassy 40 also offers a spacious engine room, an exceptional feature for a vessel of this size, providing easy access to systems and room for additional installations. Powered by a Volvo Penta D2-55, this model has a motoring range of up to 900 nautical miles in calm conditions, enabling dependable long-distance cruising.

This particular Hallberg-Rassy 40 stands out with its low-hour engine and history of light use, which is evident in its near-new interior condition. Equipped with push-button sailing for ease of operation, even with a single-handed crew, recent upgrades include brand new sails (not yet used) and refreshed canvas work as well as Gennaker equipment and radar. Stored indoors and sailed exclusively in the fresh waters of the Baltic Sea, this yacht represents an exceptional opportunity for those seeking a high-quality, ready-to-sail vessel. Contact broker for more info or to book a visit.

### Key Facts:

- Main sail and Genoa that is never used – 2024.
- Electric in mast furling system.
- Electric winches.
- Low hour engine, only 870h.
- Bow thruster.
- Webasto heater.
- Insulated hull.
- Radar.

- Autopilot.
- New cockpit cover.
- Gennaker.
- Liferaft.
- Progressive, cardan linked rod steering.
- Interior in excellent condition.

Explore more photos here: <https://www.berthoninternational.com/yacht-sales-brokerage/yachts-for-sale/hallberg-rassy-40-idunn/>

## CONSTRUCTION

*RCD Status: The yacht conforms with the essential safety requirements of Directive 94/25EC or RCDII (2013/53/EU as appropriate (Recreational Craft Directive) and is categorised A – “Ocean” (or Cat B – whichever is appropriate)*

### Hull, Deck & Superstructure Construction:

- White hull with blue trim lines.
- Integrated rubbing strake with stainless steel protection strips.
- Deep bilge.
- Epoxy treated with 5 x layers epoxy at Hallberg-Rassy.
- Antifouling (Hempel hard racing) – 2024.
- Solid teak on deck, coach roof, cockpit and swimming platform.
- Five hatches, 10 opening port holes.
- Integrated bathing platform in transom.

### Keel & Rudder:

- The keel is bolted to the bilge.
- Skeg hung rudder.

## MACHINERY

### Engine & Gearboxes:

- 1 x Volvo Penta D2-55, 55hp – approx. 870 hrs as per October 2024.
- Hydraulic gearbox.
- Diesel pre filter (Volvo Penta).

### Propulsion & Steering:

- Bow thruster, 8hp (Lewmar).
- Shaft drive.
- Shaft coupling (Centaflex).
- 3-blade folding propeller (Flexofold).
- 3-blade fixed propeller as spare.
- Progressive, cardan linked rod steering.
- Steering wheel, stainless, covered with skin.
- Emergency steering gear.

## ELECTRICAL SYSTEMS

### Voltage Systems:

- 12V battery system.

- 230V shore power system.

**Battery Banks:**

- Start battery 12V / 80Ah – 2020.
- Service batteries, 480Ah, 4 x 6V x 240Ah (Trojan T125 deep cycle) – 2023.

**Battery Chargers:**

- Battery charger 230V / 12V / 50A (Mastervolt IVO Smart).

**Alternators:**

- Alternator 115A.

**Shore Power:**

- 230V shore connection, isolator, circuit breaker, shore cable, 3 x outlets.

**Other Electrical:**

- Battery control panel (Mastervolt).
- Isolation transformer.

**PLUMBING SYSTEMS****Fresh Water & Water Heating System:**

- Hot water boiler approx. 40L.

**Bilge Pumps:**

- Manual bilge pump.
- Electric, high capacity bilge pump.

**TANKAGE****Fuel:**

- Fuel capacity approx. 460L.
- Stainless steel tank.

**Fresh Water:**

- Fresh water capacity approx. 460L.
- Stainless steel tank.

**Grey/Blackwater Holding Tanks:**

- Holding tank capacity approx. 72L.
- Stainless steel tanks, deck or gravity drained.

**NAVIGATION EQUIPMENT**

- Compass, illuminated.
- Autopilot with drive on quadrant (Raymarine ST 6002).
- Wireless remote control for autopilot.
- Plotter/MFD (Raymarine 120 12").
- Radar on back stay (Raymarine).
- Self-levelling radar mount (Scanstrut).

- AIS (Raymarine 650) – 2015.
- 3 x Multi instruments (Raymarine ST60).
- VHF (Raymarine Ray 49E flush mounted) – 2016.
- Antenna (RR Pacific).

## DOMESTIC EQUIPMENT

### Galley:

- Gas stove with 2 burners and oven (ENO).
- Fridge box with 12V water cooled compressor (isotherm).
- Mixer tap for hot and cold pressurized freshwater.
- Double sinks.

### Heads/Showers:

- 1 x Marine toilet (Jabsco).
- Mixer tap for hot and cold pressurized freshwater.
- Shower tap.
- Shower drain pump 12V.
- Ventilation.

### Heating & Ventilation:

- Diesel heating system with outlets in all cabins/bathrooms (Webasto IRTOP 3,5kW).
- 2 x Ventilators (Dorade).
- 4 x Ventilators (low profile in stainless steel).

### Entertainment:

- Radio/CD (Clarion).
- 2 x Speakers in saloon.
- 2 x speakers in cockpit (Sea&Symphonie).
- TV LCD in saloon.

### Lighting:

- All direct interior lights LED, indirect Halogen.
- Reading light on chart table and at the beds.

## ACCOMMODATION

### Summary of Accommodation:

- 5 berths in 2 cabins and saloon.
- Headroom in salon is 192cm.
- Possible to use saloon sofa as berth.
- 2 x comfortable armchairs with storage beneath.
- Mahogany interior in matt silk finish.
- Floor in varnished teak with inlaid holly strips.
- Light grey upholstery with small blue anchors.
- Light grey carpets – 2016.
- White curtains.
- White ceiling with mahogany strips and teak grabrails.
- Curtains for skylight in sleeping cabins.
- Ship clock and barometer (Wempe and Quartz).

## Internal Layout:

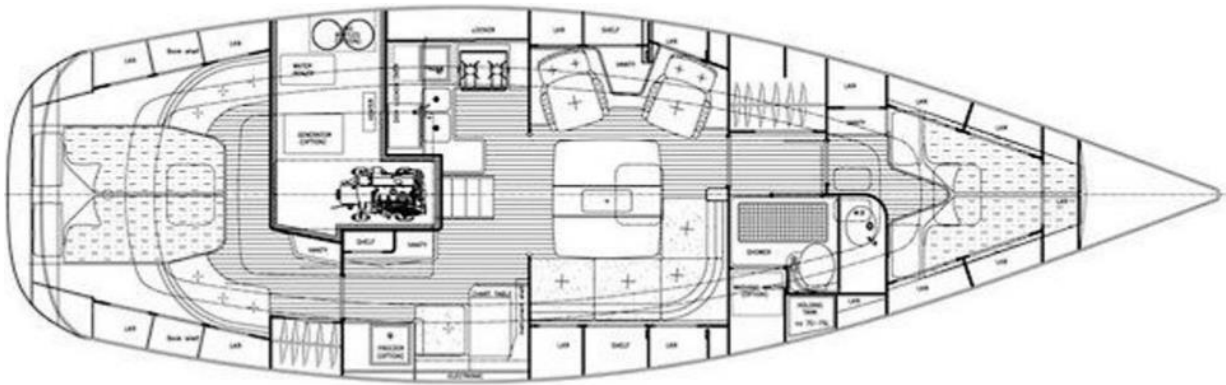

## Description of layout from forwards:

### Forward Cabin:

- Forward guest cabin with V-berths, convertible to a double berth with insert plate.
- Plenty of storage in drawers, lockers and shelves.
- Skylight with curtains.
- Separate door to retain privacy.

### Forward Walkthrough:

- Plenty of storage in wardrobes.
- Access to the head.

### Heads:

- Head with separate shower area.
- Storage in lockers.
- Wash basin and work top in composite stone (PlexiCor).
- Large mirror.

### Saloon:

- Spacious and bright saloon with an L-sofa, two armchairs and 6 x portlights.
- Solid table with foldable sides.
- Plenty of storage in the seating area, lockers and shelves.
- Open social area connected to galley and nav station.
- Entrance stair.
- Access to front side of engine.

### Galley:

- The galley is located directly to port of the entrance.
- Plenty of storage in lockers and drawers.
- Big working surface in composite stone (PlexiCor).
- Strong round mahogany fiddle rail.
- Twin burner gas cooker with oven.

### Navigation Area:

- Located directly to starboard of the entrance. Includes a comfortable seat, chart table, drawers for storage and space for instruments and electrical panel.

**Aft Walkthrough:**

- Rubber sealed two-door access to the sound insulated engine room.
- Locker and bookshelves.

**Aft Cabin:**

- Bright owner's aft cabin with a queen size centre berth and 2 x small sofas.
- 1 x Skylight.
- Plenty of storage in wardrobes, lockers, shelves and under berths.
- Access to battery banks and steering mechanism.

**DECK EQUIPMENT****Rig:**

- In-mast furling mast (Seldén).
- Triple spreader rig.
- Electric main sail furling system.
- Furler for genoa (Seldén 300).
- Boomvang (Rodkick Seldén)
- Manual backstay tensioner.
- Aluminium rigging screw protection.
- Removable bow sprit.
- Deck light.
- Steaming light.
- Anchor light.
- Windex.
- Flag halyards.

**Winches:**

- 2 x Electric (Lewmar 50).
- 2 x Electric (Lewmar 30).
- 2 x Halyard winches on mast, manual (Lewmar 40).

**Sails:**

- Furling main with standing battens, laminate (Elvström) – 2024 never used.
- Genoa, laminate, approx. 130% (Elvström) – 2024 never used.
- Older furling main with battens, laminate (Kinneviken) – 2010.
- Older genoa, laminate and UV-protection, E-foam reef compensator, approx. 135% (Kinneviken) – 2010.
- Older Jib with E-foam reef compensator.
- Staysail.
- Gennaker with sock.

**General:**

- Fixed windscreen, opening mid window.
- Grab rail at pedestal, sprayhood and outside the windscreen.
- High gloss varnished entrance and chart table with integrated teak fiddle rails.
- Varnished foldable cockpit table.
- Push-button control on helm pedestal for electric mainsheet and outhaul.
- 2 x G&T seats in stern.
- Shower at bathing platform.

- Safety/Swim ladder.
- 2 x Ventilators (Dorade).
- 4 x Ventilators (stainless steel)
- 5 x Skylights.
- 10 x openable portlights.
- Deck gear (Lewmar).
- 2 x Gas bottles

#### **Anchoring & Mooring Equipment:**

- Bow - Windlass, electric (Lewmar), Anchor 20kg (Delta), 60m x 8mm galvanised chain.
- Extra anchor bow roller.
- Remote control for windlass at steering pedestal.
- Stern - Anchor 20kg (Bruce) on anchor roller with lead line, controlled by electric winch.
- 4 x Cleats.
- 2 x Spring cleats.
- 4 x Mooring lines.
- 6 x Fenders with covers.
- Boat hook.
- Anchor line system on pushpit with buoy hook.
- Lifeline gates on SB and Port side.

#### **Covers, Canvas & Cushions:**

- Sprayhood with stainless steel frame – 2022.
- Cockpit cover in new condition, never used.
- Winter cover for cockpit in new condition, never used.
- Bimini top with stainless steel frame (Rössy) in new condition, never used.
- Cockpit cushions.
- Cover for steering pedestal (Rössy) – 2015.

#### **SAFETY EQUIPMENT**

- Liferaft (Viking), need service – 2010.
- Rescue sling.
- Horse shoe buoy.
- Safety ladder.

#### **Fire-Fighting Equipment:**

- 3 x Fire extinguishers.

# BERTHON

INTERNATIONAL YACHT BROKERS

**Berthon UK**

Bath Road  
Lymington  
Hampshire  
SO41 3YL  
England

0044 (0)1590 679 222  
brokers@berthon.co.uk  
berthoninternational.com

**Berthon Scandinavia**

Ängsvägen 12  
473 33  
Härnäs  
Sweden

0046 304 694 000  
brokers@berthonscandinavia.se  
berthonscandinavia.com

**Berthon Spain (Yacht Sales)**

Edificio Reina Constanza  
Calle Porto Pi 8 - 8B  
07015  
Palma de Mallorca  
Spain

0034 871 044 659  
brokers@berthonspain.com  
berthonspain.com

**Berthon Spain (Yacht Services)**

Carrer de Can Rius 14 - Local 1  
07610  
Palma de Mallorca  
Spain

0034 971 415 441  
services@berthonspain.com  
berthonspain.com

**Berthon USA**

40 Mary Street  
Newport  
Rhode Island  
02840  
USA

001 401 846 8404  
sales@berthonusa.com  
berthonusa.com

*DISCLAIMER These particulars have been prepared from information provided by the vendors and are intended as a general guide to the yacht, their accuracy cannot be guaranteed by us. The purchaser should confirm details of concern to them by survey or engineer's inspection. The purchaser should also ensure that the purchase contract properly reflects their concerns and specifies details on which they may wish to rely.*