



Arcona 465 Carbon > MIKAELA



Price	€580,000 VAT paid
Location	Henån, Sweden
Year	2017
LOA	46'3" / 14.09m
LWL	45'6" / 13.25m
Beam	13'11" / 4.24m
Draft	8'2" / 2.5m
Displacement	9,550kg / 21,054lb
Hull Material	Carbon
Engine	1 x Yanmar 4JH80, 80hp
Builder	Arcona Yachts
Designer	Stefan Qviberg
Accommodation	6 berths in 3 cabins



BROKER'S COMMENTS

The superlatives from the sailing press were great when the Arcona 465 Carbon was introduced in 2017. No wonder; this is a very fast, modern, well-built and highly appealing performance cruiser from the renowned yard located in Sweden.

As the name says, this is a fully carbon-built yacht. It was designed for sailors that are looking for both racing and cruising. The light displacement due to the carbon makes the yacht perfectly fit for racing and also allows you to bring the additional gear that is needed for cruising.

Arcona 465 Carbon, MIKAELA is a very lightly used yacht that has spent about half her time on the Swedish east coast and the other half on the Swedish west coast. She has only been used for family cruising for about 3 weeks per year between June and August with her first and current Swedish owner. MIKAELA is nicely equipped with a carbon mast and boom, teak deck and a beautifully hand-crafted mahogany interior.

The layout includes a forward owner's cabin with en suite heads/shower, a large and light saloon with sofa and two comfortable armchairs. Directly at the entrance you will find the navigation area, an L-shaped galley and an additional head. In the aft part of the yacht there are two aft cabins with double berths.

This is a yacht in very good general condition, ready for more cruising or racing as you wish.

Key Facts:

- Carbon mast.
- Carbon boom.
- Rod rigging.
- Hydraulic aft stay tensioner.
- Mast Jack system.
- Main, Jib, Cutter jib and Gennaker.
- Electric halyard winch.
- Carbon steering wheels.
- Teak deck.
- Complete navigation system (B&G).
- Yanmar 80 hp engine.
- Mahogany interior
- 3-cabin layout.
- Lithium batteries.
- EFOY fuel cell.
- And much more...

Explore more photos here: <https://www.berthoninternational.com/yacht-sales-brokerage/yachts-for-sale/arcona-465-carbon-mikaela/>

OWNER'S COMMENTS

Arcona 465 MIKAELA is our 2nd Arcona yacht. When getting ready to upgrade from our 2004 Arcona 370, we wanted to stay loyal to the Arcona brand, as we were deeply impressed with the sailing performance and excellent craftsmanship. In the summer of 2016, former Arcona CEO and Owner, Mr. Torgny Jansson, took us for a demo in a fresh breeze on Baggensfjärden in the Stockholm archipelago. The decision to order a brand new A465, for delivery 2017, was taken the next day!

The performance and ease of handling of the Arcona 465 Carbon is nothing but stunning. With her slippery carbon hull, carbon rigging, bulb keel and deep rudder she showed rock solid performance in all wind conditions. We clocked 16.5 knots boat speed, flying only the jib on a broad reach between Stockholm and Västervik. MIKAELA was configured for long distance cruising in mind with a larger water tank and an additional fuel tank. All the boxes were ticked on the extra equipment list!

MIKAELA has seen very light use, 2-3 weeks per summer, cruising with mainly 2 persons onboard in Scandinavian waters. She has always been stored indoors, first at the Arcona yard in Stockholm and since 2021 at Vindövarvet on the Swedish west coast. Her future owner can look forward to ownership of a top notch cruiser/racer that will take you anywhere safely and in great comfort.

CONSTRUCTION

RCD Status: The yacht conforms with the essential safety requirements of Directive 94/25EC or RCDII (2013/53/EU as appropriate (Recreational Craft Directive) and is categorised A – “Ocean” (or Cat B – whichever is appropriate)

Hull, Deck & Superstructure Construction:

- White hull with blue trimlines.
- Hull and deck in Carbon.
- Bulkheads laminated to deck and hull.
- Epoxy and antifouling below the water line.
- Teak on deck, coach roof, cockpit and swim platform.

Keel & Rudder:

- T-shaped keel with bulb (standard 2,50 m draft).
- Spade rudder.

MACHINERY

Engine & Gearboxes:

- Yanmar 4JH80, 80hp.
- Sail drive.

Maintenance & Performance:

- Engine hours approx. 575.
- Engine professionally serviced yearly.

Propulsion & Steering:

- 3-bladed propeller (Flexofold).
- Bow thruster, retractable (Sidepower).
- Rod steering system (JEFA)
- 2 x Carbon steering wheels.

ELECTRICAL SYSTEMS

Voltage Systems:

- 12V.
- 230V.

Battery Banks:

- Service batteries 12V 270Ah Lithium (Victron).
- Start battery 12V12V 100 Ah AGM.
- Bow thruster battery 12V 100Ah AGM.

Battery Chargers:

- Battery charger / Inverter 12V / 1600VA / 70A.

Alternators:

- 12V / 125A.

Shore Power:

- 230V shore power with earth fault breaker.
- 230V outlets in all cabins and galley.

Other Electrical:

- EFOY 2800 fuel cell - 2021
- Position burglar alarm (Redknows).

PLUMBING SYSTEMS**Bilge Pumps:**

- Electric bilge pump.
- Manual bilge pump.

TANKAGE**Fuel:**

- Fuel capacity approx. 365L, two tanks 240L + additional 125L.
- Electric fuel transfer pump.

Fresh Water:

- Fresh water capacity approx. 440 L, one tank 340L + additional 100L.
- Fresh water boiler 40L.

Grey/Blackwater Holding Tanks:

- Holding tank capacity approx. 100L, two tanks 50L + 50L.

NAVIGATION EQUIPMENT

- 5 x Navigation instruments for speed, depth and wind (B&G Triton).
- 2 x Chart plotters 12" (B&G Zeus II Touch).
- Chart plotter 9" (B&G Zeus II Touch).
- 3 x Electronic charts (Navionics Platinum+).
- Autopilot (B&G)
- Autopilot drive unit (JEFA).
- Autopilot maneuver panel (B&G).
- Radar (B&G 4G broadband).
- AIS class B (B&G).
- VHF (B&G V-90).
- VHF antenna.

- 2 x Handsets for VHF.

DOMESTIC EQUIPMENT

Galley:

- Fridge box, water cooled compressor (Isotherm).
- Fridge with drawer, 49L, water cooled compressor (Isotherm).
- 3-burner gas stove with oven (ENO).

Heads/Showers:

- 2 x Electrical toilets (Sani).
- 2 x Electric shower drain pumps.

Heating & Ventilation:

- Diesel heater (Eberspracher D5).
- Insulated heating supply hoses.

Entertainment:

- Radio/CD player.
- Remote control for Radio/CD player.
- Speakers in saloon.
- Speakers in cockpit.

ACCOMMODATION

Summary of Accommodation:

- Sleeps 6 persons in 3 cabins with double berths.
- Mahogany interior.
- Silver grey upholstery.
- Spring mattresses in forward cabin.
- 2 x Ship clocks (Wempe).
- Barometer (Wempe).

Internal Layout:

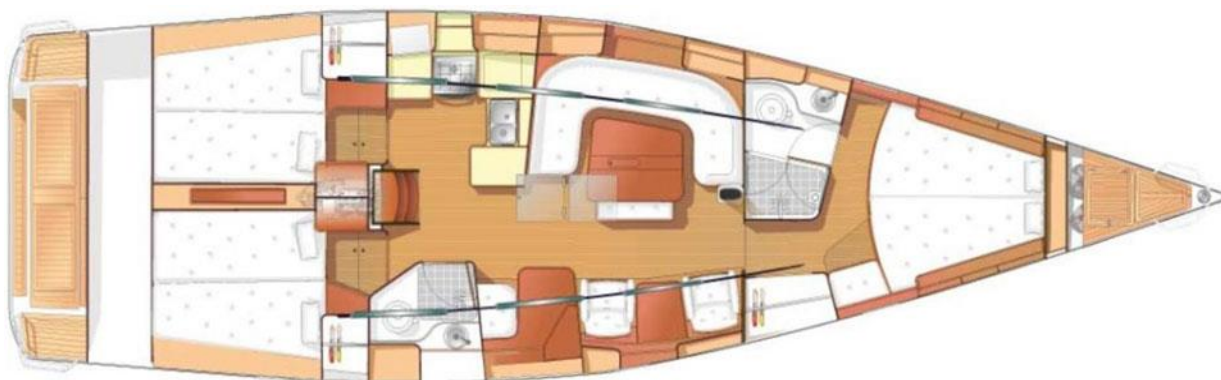

Description of layout from forwards:

- Forward cabin with double berth and en suite heads.
- Saloon with C-shaped sofa and 2 x comfortable armchairs.
- Navigation area with seat, table and drawers.

- Galley, L-shaped.
- Heads with shower.
- 2 x Aft cabins with double berths.

DECK EQUIPMENT

Rig:

- Carbon mast (Southern Spars).
- Carbon boom (Southern Spars).
- Hydraulic mast jack.
- Rod standing rigging.
- Cutter stay.
- Aft stay tensioner, hydraulic.
- Rodkick with gas strut.
- Jib furler (Seldén Furlex TD).
- Gennaker equipment.
- Gennaker halyard 2:1.
- Main and Jib sheets in Spectra.
- Windex.
- 3-color and anchor light, LED.

Winches:

- 4 x Sheet winches (Harken).
- Halyard winch, electric (Harken).

Sails:

- Main (UK, X-Drive Carbon/ polyester laminate,, Racing-battens, 2 reefs).
- Lazy bag for main sail.
- Jib (UK, G3 X-Drive Carbon/polyester laminate, vertical battens, UV-cover).
- Sail cover for jib.
- Gennaker 197 m2, 0,9 Oz. used only once (UK).
- Top down Furl including GX furler, torsions line and back twist protection).
- Jib (UK) for cutter stay.

General:

- Outboard holder.
- Shower at swim platform.
- Electric deck wash pump.
- 2 x Gas bottles.

Anchoring & Mooring Equipment:

- Bow: Electric windlass, galvanized chain, stainless steel anchor (Bruce type).
- Stern: Electric windlass, lead line, anchor davit, stainless steel anchor (Bruce type).
- 4 x Fenders.
- 2 x Fenders, round type.
- 4 x Mooring lines.
- Bow ladder.
- Lifeline gates.

Covers, Canvas & Cushions:

- Sprayhood.

- Cover for cockpit.
- Cover for steering wheels and steering pedestal.

SAFETY EQUIPMENT

- Life buoy.
- Jack stays on the deck.

Fire-Fighting Equipment:

- 3 x Fire extinguishers.

BERTHON

INTERNATIONAL YACHT BROKERS

Berthon UK

Bath Road
Lymington
Hampshire
SO41 3YL
England

0044 (0)1590 679 222
brokers@berthon.co.uk
berthoninternational.com

Berthon Scandinavia

Ängsvägen 12
473 33
Hälsånger
Sweden

0046 304 694 000
brokers@berthonscandinavia.se
berthonscandinavia.com

Berthon Spain (Yacht Sales)

Edificio Reina Constanza
Calle Porto Pi 8 - 8B
07015
Palma de Mallorca
Spain

0034 871 044 659
brokers@berthonspain.com
berthonspain.com

Berthon Spain (Yacht Services)

Carrer de Can Rius 14 - Local 1
07610
Palma de Mallorca
Spain

0034 971 415 441
services@berthonspain.com
berthonspain.com

Berthon USA

40 Mary Street
Newport
Rhode Island
02840
USA

001 401 846 8404
sales@berthonusa.com
berthonusa.com

DISCLAIMER These particulars have been prepared from information provided by the vendors and are intended as a general guide to the yacht, their accuracy cannot be guaranteed by us. The purchaser should confirm details of concern to them by survey or engineer's inspection. The purchaser should also ensure that the purchase contract properly reflects their concerns and specifies details on which they may wish to rely.