



Hallberg-Rassy 310 > **PRIOETTE**



Price	SEK1,575,000 VAT paid
Location	Onsala, Sweden
Year	2011
LOA	30'11" / 9.42m
LWL	28'10" / 8.8m
Beam	10'5" / 3.18m
Draft	5'11" / 1.8m
Displacement	4,350kg / 9,590lb
Hull Material	GRP
Engine	1 x Yanmar 3YM20, 21hp
Builder	Hallberg-Rassy AB
Designer	German Frers
Accommodation	6 berths in 2 cabins & saloon



BROKER'S COMMENTS

The Hallberg-Rassy 310 is an elegant, fast and easily maneuverable cruiser. The collaboration between German Frers and Hallberg-Rassy has been highly successful, resulting in a yacht with beautiful hull lines and a modern sail plan. As a result, 132 boats have been produced at the renowned yard in Ellös. This is a true Hallberg-Rassy yacht with all the typical details found on their larger models, such as a windshield, integrated rubbing strake, teak toe rail, and lead keel. Everything is packaged very tastefully in these 31 footers; they are a dream boat for sure!

Hallberg-Rassy is renowned for their ability to create ample space in their yachts, and this holds true for the Hallberg-Rassy 310 as well. The layout offers accommodation for up to 6 people, spread across two cabins and convertible sofas in the saloon. The interior is made of light mahogany, which, combined with good natural light, gives a surprisingly spacious feeling when you step down below. Directly to starboard at the foot of the companionway is the galley with ample storage and a stove with oven. Both the aft and forward cabins are generous in size and offer double berths and storage space. In the saloon, there is a table with folding sides and two sofas, and a protective mat covers the floor. The toilet is bright, spacious, and comes with a composite countertop. There are 11 portlights and 4 deck hatches aboard, all of which are openable and provide excellent ventilation.

The cockpit offers ample space for the whole crew, with easy access to the bathing platform through the aft opening, which can be sealed if required. The Hallberg-Rassy 310 is not only visually striking with its generous interior and cockpit spaces but is also a proven performer, triumphing in its class at the prestigious Tjörn Runt sailing race.

Hallberg-Rassy 310, PRIOETTE has lived her life on the west coast and is now sailing with her second owner. PRIOETTE boasts a high equipment level, featuring a modern conventional mast, Axiom plotter, heater and teak deck. Tiller steering not only provides a delightful sailing sensation, but in the raised position, it also offers a cockpit with superior size. This Hallberg-Rassy 310 is an ideal luxury cruiser for the Swedish archipelago, but she can take you much farther if desired.

Key Facts:

- Conventional mast from Selden Mast.
- Yanmar 3YM20 engine.
- 6 berths in 2 cabins + saloon.
- Tiller steering.
- Bowsprit for gennaker, removable.
- Code 0.
- Sprayhood with extension for cockpit.
- Teak in cockpit and on deck.
- Bathing platform with teak.
- Teak in cockpit and deck.
- Raymarine plotter – 2020.
- Autopilot.
- Webasto heater.
- AIS – 2020.
- Batteries – 2021.

Explore more photos here: <https://berthonscandinavia.se/en/yachts-for-sale/hallberg-rassy-310-prioette/>

CONSTRUCTION

RCD Status: The yacht conforms with the essential safety requirements of Directive 94/25EC or RCDII (2013/53/EU as appropriate (Recreational Craft Directive) and is categorised A – “Ocean” (or Cat B – whichever is appropriate)

Hull, Deck & Superstructure Construction:

- White hull with blue trim lines.
- Hull and deck in GRP, sandwich construction.
- Integrated rubbing strake, brass stripe.
- Teak toerail.
- Windscreen, openable mid section.
- Teak in cockpit, on deck and bathing platform.

Keel & Rudder:

- Fin keel with bulb, lead.
- GRP rudder with stainless steel rudderstock and self-aligning bearings.

MACHINERY

Engine & Gearboxes:

- Yanmar 3YM20, 21hp. Approx. 700 hours (display out of order).

Propulsion & Steering:

- Tiller steering.
- Tiller extension (Spinlock).
- S-drive.
- Folding propeller, 3-blade (Gori).

ELECTRICAL SYSTEMS

Battery Banks:

- 2 x Service batteries 12V/ 240Ah – 2021.
- 1 x Start battery 12V/ 80 Ah – 2021.

Battery Chargers:

- Charger 230V / 12V/ 35A (Mastervolt).

Alternators:

- Alternator 12V/125A.

Shore Power:

- 220V shore power system with earth fault breaker.

Other Electrical:

- DC control panel.
- 12V outlets.
- 230V outlets.
- Solar panel.

PLUMBING SYSTEMS

Fresh Water & Water Heating System:

- Total hot water capacity of 20 litres.

Bilge Pumps:

- Manual bilge pump.
- Electric bilge pump.

TANKAGE

Fuel:

- Total capacity of 100 litres.

Fresh Water:

- Total capacity of 200 litres.

Grey/Blackwater Holding Tanks:

- Total holding tank capacity of 50 litres, deck and sea evacuation.

Gas:

- Gas bottle, 6kg.

NAVIGATION EQUIPMENT

- 1 x Compass with light (Silva).
- Plotter Axiom 9" (Raymarine) – 2020.
- 1 x Multi instrument FI-50 (Furuno); speed, depth, log.
- 1 x Wind instrument FI-50 (Furuno).
- Compass at companionway.
- Autopilot for tiller with control unit, SPX-5 GP (Raymarine).
- AIS – 2020.
- VHF, handheld HH-500 (Cobra Marine).
- VHF antenna.

DOMESTIC EQUIPMENT

Galley:

- Stove with 2 burners and oven (ENO).
- Double sink with water tap.
- Pressurized water.
- Fridge.

Heating & Ventilation:

- Diesel heater incl 4 outlets (Webasto Airtop 3900).
- 4 x Skylights.
- 11 x Portlights.
- 2 x Dorado vents.

Entertainment:

- Stereo MS-RA70N (Fusion), 2 x speakers in saloon and cockpit.

- TV 19".
- TV antenna.

Lighting:

- Reading Lights.

ACCOMMODATION

Summary of Accommodation:

- 6 berths in 2 cabins and saloon.
- Interior in mahogany, matt silk finish.
- Light grey cushions.
- Floorboards with holly strips, inspection hatches.
- 4-6 berths, owner's cabin, guest cabin and saloon.
- Heads with shower.
- L-sofa on port side, centerline foldable leaf table.
- Sofa port side.
- White inner ceiling, mahogany strips.
- Spotlights.
- Carpets, dark grey.
- Curtains for portlights and skylights.

Internal Layout:

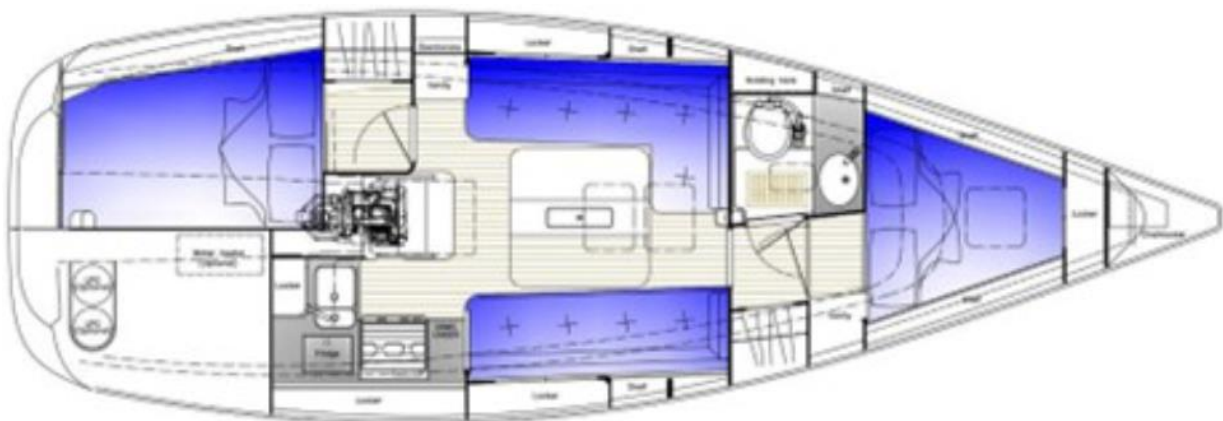

Description of layout from forwards:

- Owner's cabin with double V-berth.
- Wardrobe and cupboard.
- Heads with shower.
- Spacious saloon with ample of storage.
- Centerline foldable saloon table with wine rack.
- Navigation area port side.
- L-shape galley on starboard side.
- Aft cabin with double berth.
- Wardrobe, shelf and storage under bed.

DECK EQUIPMENT

Rig:

- Fractional 2-spreader mast (Seldén Mast).
- Conventional mast, MDS system.
- Boom with single line reef system.
- Furling system forestay, below deck (Furlex TD).
- Rodkick with gas spring.
- Backstay bridle with block system.
- Gennaker equipment.
- Windex.
- Aluminium rigging screw covers.
- Lazy-Jacks.

Winches:

- 2 x Genoa winch 40CST (Lewmar).
- 2 x Halyard winch 16CST (Lewmar).

Sails:

- Main, EPEX-laminate (Elvström).
- Furling jib, EPEX-laminate (Elvström).
- Code 0.

General:

- Grab handles on coach roof.
- Adjustable bracket for plotter.
- Safety/swim ladder, stainless steel.
- Genoa tracks, adjustable from cockpit.
- Protection strips at all cleats.
- Shower at bathing platform.
- Flag pole.

Anchoring & Mooring Equipment:

- 6 x Mooring cleats, stainless steel.
- 6 x Mooring lines.
- 6 x Fenders.
- Bow: Anchor fitting, Anchor with rope.
- Stern: Bruce type anchor 10kg with fitting at pushpit, Ankarolina.

Covers, Canvas & Cushions:

- Sprayhood with extension, cockpit canopy beige.
- Cockpit table, foldable (Lagun).
- Storage locker starboard side.
- Boom cover.
- Tiller cover.

Tender & Outboard:

- Outboard bracket on pushpit.

SAFETY EQUIPMENT

- Hansa line with holder.

Fire-Fighting Equipment:

- 2 x Fire extinguishers.

BERTHON

INTERNATIONAL YACHT BROKERS

Berthon UK

Bath Road
Lymington
Hampshire
SO41 3YL
England

0044 (0)1590 679 222
brokers@berthon.co.uk
berthoninternational.com

Berthon Scandinavia

Ängsvägen 12
473 33
Henån
Sweden

0046 304 694 000
brokers@berthonscandinavia.se
berthonscandinavia.com

Berthon Spain (Yacht Sales)

Edificio Reina Constanza
Calle Porto Pi 8 - 8B
07015
Palma de Mallorca
Spain

0034 871 044 659
brokers@berthonspain.com
berthonspain.com

Berthon Spain (Yacht Services)

Carrer de Can Rius 14 - Local 1
07610
Palma de Mallorca
Spain

0034 971 415 441
services@berthonspain.com
berthonspain.com

Berthon USA

40 Mary Street
Newport
Rhode Island
02840
USA

001 401 846 8404
sales@berthonusa.com
berthonusa.com

DISCLAIMER These particulars have been prepared from information provided by the vendors and are intended as a general guide to the yacht, their accuracy cannot be guaranteed by us. The purchaser should confirm details of concern to them by survey or engineer's inspection. The purchaser should also ensure that the purchase contract properly reflects their concerns and specifies details on which they may wish to rely.